

) B O E 7 B M W F

4 I V Q O G G 7 B M W

& K D U D F W H

- 7 K H + D Q G Y D O Y H W K X U W Q R I R Q D D O Y G H R I I D D S Q H S X P H D W W I R F U E D H V R U R X L
- 7 K H W K U H H Z D \ S U H V V X U H U H O L H I W I S H L V R O D W H K H V G R F Z Q V W
- W I S H V D U H D Y D L O D E O H W R I L W W K H D S S O L F D W L R Q U H T X L U H

& P Θ ς Ω Υ Ξ Φ

Z D \ Y D O Y H Z D \ Y D O Y H

* U D S K L F D O U H S U H V H Q D W L R Q U H S U H V H Q D W L R Q

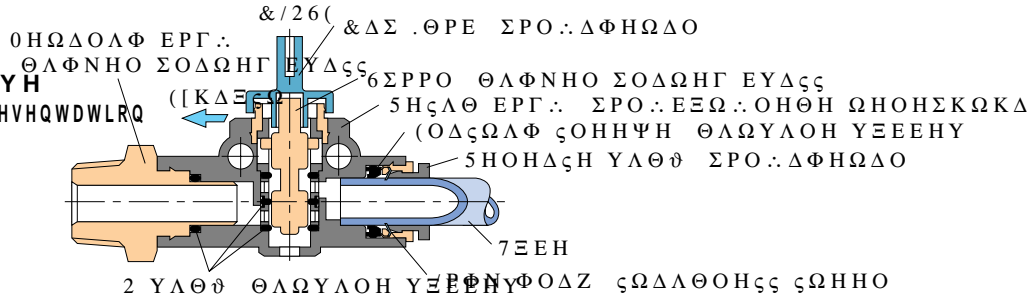
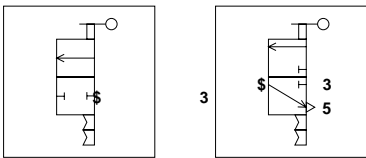

6 Σ Η Φ Λ Ι Α Φ

| | |
|--|--|
| | |
| | |
| | |
| | |

Ο Ρ Γ Η Ο ε Η ς Λ Θ Θ Δ Ω Λ Ρ

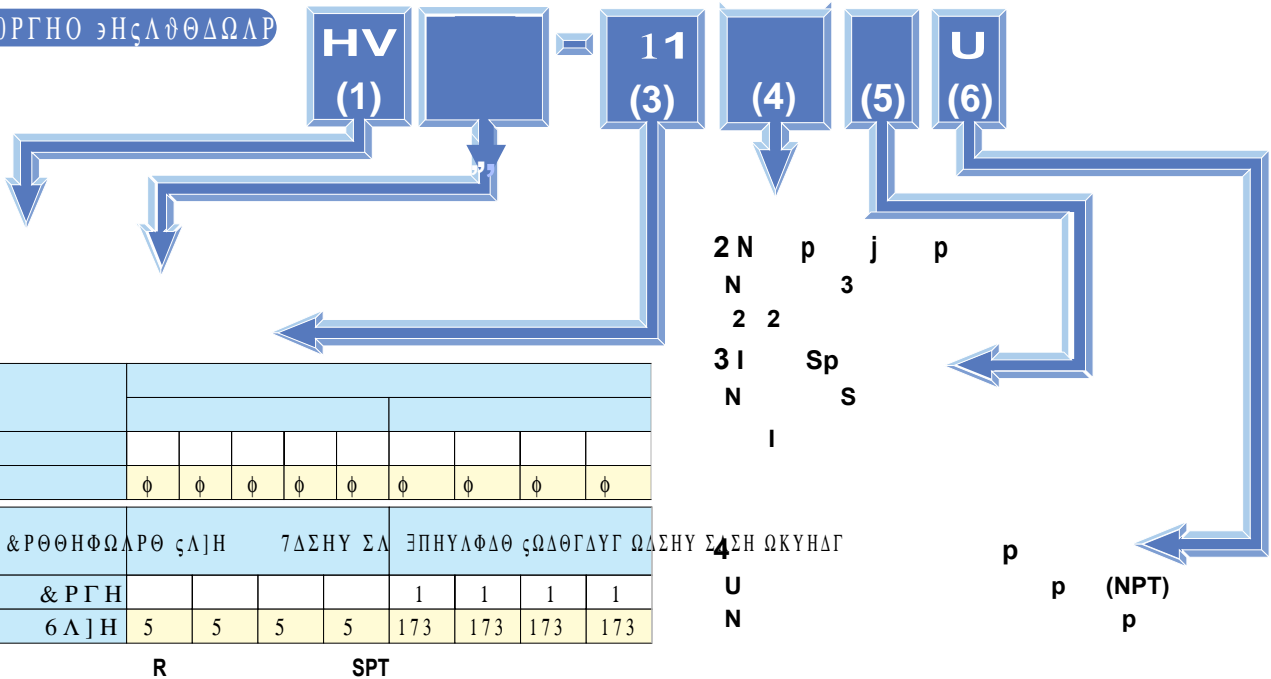

Ξ Ε Ρ Ε Ω Ζ Δ : : Δ Θ Γ

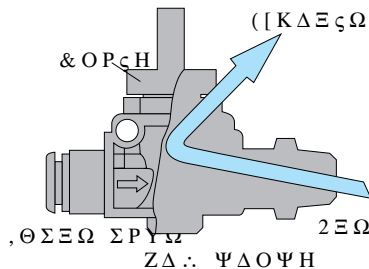

- 7 K H Ω Κ Υ Η Η Ζ Δ : : Ψ Δ Ο Ψ Η Υ Η Ο Η Δ ς Η ς Ω Κ Η Υ Η ς Λ Γ Ε Δ Ο Φ Ρ Θ Θ Η Φ Ω Η Γ Ζ Κ Η Θ Φ Ω Ξ Υ Θ Λ Θ Ω Ρ Ε Ι Θ Η Φ Η ς ς Δ Υ : : Ω Ρ ς ς : : ς Ω Η Π ς Δ Θ Δ Λ Θ ς Ω Π Δ Ο Ι Ε Θ Φ Ω Λ Ρ Θ Ρ Υ Γ Η Φ Υ Η Δ ς Η Ω Π Δ : : Ε Η Π Δ Λ Θ Ω Κ Η Ω Η Ψ : : Ψ Δ Ο Ψ Η Κ Ρ Ο Γ ς Ω Κ Η Σ Υ Η ς ς Ε Ι Ρ Υ Ω Κ Η Δ Σ Σ Ο Λ Φ Δ Ω Λ Ρ Θ Ζ Κ Η Υ Η Ω Κ Η Υ Η ς Λ Γ Ε Δ Ο Σ Υ Η Ω Δ Θ Ν Ρ Υ ς Ρ Π Η Ψ Δ Φ Ξ Ε Π ς : : ς Ω Η Π

| MODEL | Tube dia. ϕ | NPT | A | B2 | C | E1 | E2 | F1 | F2 | B1 | H | Weight (g) | Orifice ϕ mm | Eff. A. mm^2 | Cv |
|------------|------------------|-----|------|------|------|------|------|------|------|------|-------|------------|-------------------|-----------------------|------|
| HV3/16-N1U | 3/16 | 1/8 | 0.31 | 1.59 | 0.67 | 1.02 | 1.16 | 0.71 | 0.31 | 0.67 | 9/16 | 33.7 | 4.0 | 5.1 | 0.27 |
| HV3/16-N2U | 3/16 | 1/4 | 0.43 | 1.59 | 0.67 | 1.02 | 1.20 | 0.71 | 0.31 | 0.67 | 9/16 | 39.6 | 4.0 | 5.1 | 0.27 |
| HV3/16-N3U | 3/16 | 3/8 | 0.47 | 1.59 | 0.67 | 1.02 | 1.26 | 0.71 | 0.31 | 0.67 | 11/16 | 53.3 | 4.0 | 5.2 | 0.28 |
| HV1/4-N1U | 1/4 | 1/8 | 0.31 | 1.59 | 0.67 | 1.02 | 1.16 | 0.71 | 0.31 | 0.67 | 9/16 | 33.8 | 5.0 | 7.5 | 0.40 |
| HV1/4-N2U | 1/4 | 1/4 | 0.43 | 1.59 | 0.67 | 1.02 | 1.20 | 0.71 | 0.31 | 0.67 | 9/16 | 39.8 | 5.0 | 7.7 | 0.41 |
| HV1/4-N3U | 1/4 | 3/8 | 0.47 | 1.59 | 0.67 | 1.02 | 1.26 | 0.71 | 0.31 | 0.67 | 11/16 | 53.3 | 5.0 | 7.5 | 0.40 |
| HV5/16-N1U | 5/16 | 1/8 | 0.31 | 1.59 | 0.71 | 1.10 | 1.16 | 0.71 | 0.31 | 0.83 | 9/16 | 34.8 | 5.0 | 8.7 | 0.47 |
| HV5/16-N2U | 5/16 | 1/4 | 0.43 | 1.59 | 0.71 | 1.10 | 1.20 | 0.71 | 0.31 | 0.83 | 9/16 | 40.7 | 5.0 | 8.9 | 0.48 |
| HV5/16-N3U | 5/16 | 3/8 | 0.47 | 1.59 | 0.71 | 1.10 | 1.26 | 0.71 | 0.31 | 0.83 | 11/16 | 54.4 | 5.0 | 8.6 | 0.46 |
| HV3/8-N2U | 3/8 | 1/4 | 0.43 | 1.61 | 0.79 | 1.28 | 1.44 | 0.94 | 0.43 | 0.83 | 11/16 | 63.0 | 5.0 | 16.2 | 0.87 |
| HV3/8-N3U | 3/8 | 3/8 | 0.47 | 1.61 | 0.79 | 1.28 | 1.46 | 0.94 | 0.43 | 0.83 | 11/16 | 71.3 | 7.0 | 16.0 | 0.86 |
| HV3/8-N4U | 3/8 | 1/2 | 0.59 | 1.61 | 0.79 | 1.28 | 1.48 | 0.94 | 0.43 | 0.83 | 7/8 | 94.3 | 7.0 | 15.7 | 0.85 |
| HV1/2-N2U | 1/2 | 1/4 | 0.43 | 1.61 | 0.93 | 1.38 | 1.44 | 0.94 | 0.43 | 0.83 | 11/16 | 65.5 | 7.0 | 16.3 | 0.88 |
| HV1/2-N3U | 1/2 | 3/8 | 0.47 | 1.61 | 0.93 | 1.38 | 1.46 | 0.94 | 0.43 | 0.83 | 11/16 | 73.9 | 7.0 | 16.3 | 0.88 |
| HV1/2-N4U | 1/2 | 1/2 | 0.59 | 1.61 | 0.93 | 1.38 | 1.52 | 0.94 | 0.43 | 0.83 | 7/8 | 96.8 | 7.0 | 16.1 | 0.87 |

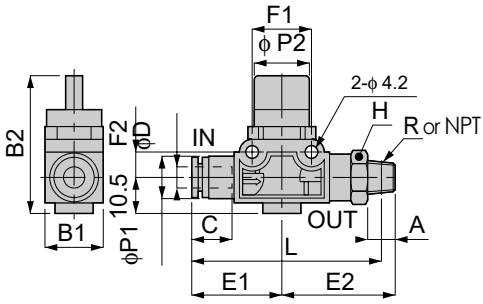

| Model | Tube O.D. ϕ D1 | R | A | B1 | B2 | L | ϕ P1 | ϕ P2 | Tube end C | E1 | E2 | H | F1 | F2 | Eff. area (mm^2) | Weight (g) | CAD file name |
|------------|---------------------|------|----|------|------|------|-----------|-----------|------------|------|------|----|----|----|-----------------------------|------------|---------------|
| HV6-01- | 6 | R1/8 | 8 | | | 55.9 | | | | 33.5 | | 14 | | | 7.5 | 34 | HV6-01_ |
| HV6-02- | | R1/4 | 11 | 17 | 40.5 | 56.8 | 12.5 | 16.5 | 17 | 26.4 | 36.5 | 17 | 18 | 8 | 7.7 | 40 | HV6-02_ |
| HV6-03- | | R3/8 | 12 | | | 58.3 | | | | | 38.3 | 17 | | | 7.5 | 53 | HV6-03_ |
| HV8-01- | 8 | R1/8 | 8 | | | 57.2 | | | | 33.5 | | 14 | | | 8.7 | 35 | HV8-01_ |
| HV8-02- | | R1/4 | 11 | 17 | 40.5 | 58.2 | 15 | 16.5 | 18.1 | 27.7 | 36.5 | 14 | 18 | 8 | 8.9 | 41 | HV8-02_ |
| HV8-03- | | R3/8 | 12 | | | 59.7 | | | | | 38.3 | 17 | | | 8.6 | 54 | HV8-03_ |
| HV10-02- | 10 | R1/4 | 11 | | | 68.7 | | | | 42.5 | | 17 | | | 16.2 | 62 | HV10-02_ |
| HV10-03- | | R3/8 | 12 | 21.7 | 41 | 69.4 | 17.5 | 19.5 | 20.2 | 32.2 | 43.5 | 21 | 24 | 11 | 16 | 71 | HV10-03_ |
| HV10-04- | | R1/2 | 15 | | | 70.5 | | | | | 46.5 | 21 | | | 15.7 | 93 | HV10-04_ |
| HV12-02- | 12 | R1/4 | 11 | | | 71.4 | | | | 42.5 | | 17 | | | 16.3 | 66 | HV12-02_ |
| HV12-03- | | R3/8 | 12 | 21.7 | 41 | 72.1 | 21 | 19.5 | 23.4 | 34.9 | 43.5 | 21 | 24 | 11 | 16.3 | 74 | HV12-03_ |
| HV12-04- | | R1/2 | 15 | | | 73.2 | | | | | 46.5 | 21 | | | 16.1 | 96 | HV12-04_ |
| HV1/4-01- | 1/4 | R1/8 | 8 | | | 55.9 | | | | 33.5 | | 14 | | | 8.2 | 34 | HV1_4-01_ |
| HV1/4-02- | | R1/4 | 11 | 17 | 40.5 | 56.8 | 12.5 | 16.5 | 17 | 26.4 | 36.5 | 14 | 18 | 8 | 8 | 40 | HV1_4-02_ |
| HV1/4-03- | | R3/8 | 12 | | | 58.3 | | | | | 38.3 | 17 | | | 8.2 | 53 | HV1_4-03_ |
| HV5/16-01- | 5/16 | R1/8 | 8 | | | 57.2 | | | | 33.5 | | 14 | | | 8.7 | 35 | HV5_16-01_ |
| HV5/16-02- | | R1/4 | 11 | 17 | 40.5 | 58.2 | 15 | 16.5 | 18.1 | 27.7 | 36.5 | 14 | 18 | 8 | 8.9 | 41 | HV5_16-02_ |
| HV5/16-03- | | R3/8 | 12 | | | 59.7 | | | | | 38.3 | 17 | | | 8.6 | 54 | HV5_16-03_ |
| HV3/8-02- | 3/8 | R1/4 | 11 | | | 68.7 | | | | 42.5 | | 17 | | | 15.4 | 63 | HV3_8-02_ |
| HV3/8-03- | | R3/8 | 12 | 21.7 | 41 | 69.4 | 17.5 | 19.5 | 20.2 | 32.2 | 43.5 | 21 | 24 | 11 | 15.7 | 71 | HV3_8-03_ |
| HV3/8-04- | | R1/2 | 15 | | | 70.5 | | | | | 46.5 | 21 | | | 15.4 | 93 | HV3_8-04_ |

❖ R thread is same as BSPT



| MODEL | Tube dia. ϕ | NPT | A | B2 | C | E1 | E2 | F1 | F2 | B1 | H | Weight (g) | Orifice ϕ mm | Eff. A. mm^2 | Cv |
|------------|------------------|-----|------|------|------|------|------|------|------|------|-------|------------|-------------------|-----------------------|------|
| HVN1-3/16U | 3/16 | 1/8 | 0.31 | 1.59 | 0.67 | 1.02 | 1.16 | 0.71 | 0.31 | 0.67 | 9/16 | 34.0 | 4.0 | 5.6 | 0.30 |
| HVN2-3/16U | 3/16 | 1/4 | 0.43 | 1.59 | 0.67 | 1.02 | 1.2 | 0.71 | 0.31 | 0.67 | 9/16 | 39.8 | 4.0 | 6.0 | 0.32 |
| HVN3-3/16U | 3/16 | 3/8 | 0.47 | 1.59 | 0.67 | 1.02 | 1.26 | 0.71 | 0.31 | 0.67 | 11/16 | 53.5 | 4.0 | 5.7 | 0.30 |
| HVN1-1/4U | 1/4 | 1/8 | 0.31 | 1.59 | 0.67 | 1.02 | 1.16 | 0.71 | 0.31 | 0.67 | 9/16 | 33.8 | 5.0 | 8.3 | 0.44 |
| HVN2-1/4U | 1/4 | 1/4 | 0.43 | 1.59 | 0.67 | 1.02 | 1.20 | 0.71 | 0.31 | 0.67 | 9/16 | 39.5 | 5.0 | 8.5 | 0.46 |
| HVN3-1/4U | 1/4 | 3/8 | 0.47 | 1.59 | 0.67 | 1.02 | 1.26 | 0.71 | 0.31 | 0.67 | 11/16 | 53.5 | 5.0 | 8.2 | 0.44 |
| HVN1-5/16U | 5/16 | 1/8 | 0.31 | 1.59 | 0.71 | 1.10 | 1.16 | 0.71 | 0.31 | 0.83 | 9/16 | 35.1 | 5.0 | 8.9 | 0.48 |
| HVN2-5/16U | 5/16 | 1/4 | 0.43 | 1.59 | 0.71 | 1.10 | 1.20 | 0.71 | 0.31 | 0.83 | 9/16 | 40.9 | 5.0 | 8.9 | 0.48 |
| HVN3-5/16U | 5/16 | 3/8 | 0.47 | 1.59 | 0.71 | 1.10 | 1.26 | 0.71 | 0.31 | 0.83 | 11/16 | 54.6 | 5.0 | 8.9 | 0.48 |
| HVN2-3/8U | 3/8 | 1/4 | 0.43 | 1.61 | 0.79 | 1.28 | 1.44 | 0.94 | 0.43 | 0.83 | 11/16 | 63.1 | 7.0 | 16.6 | 0.89 |
| HVN3-3/8U | 3/8 | 3/8 | 0.47 | 1.61 | 0.79 | 1.28 | 1.46 | 0.94 | 0.43 | 0.83 | 11/16 | 71.3 | 7.0 | 16.9 | 0.91 |
| HVN4-3/8U | 3/8 | 1/2 | 0.59 | 1.61 | 0.79 | 1.28 | 1.48 | 0.94 | 0.43 | 0.83 | 7/8 | 94.4 | 7.0 | 16.5 | 0.89 |
| HVN2-1/2U | 1/2 | 1/4 | 0.43 | 1.61 | 0.93 | 1.38 | 1.44 | 0.94 | 0.43 | 0.83 | 11/16 | 65.8 | 7.0 | 17.0 | 0.92 |
| HVN3-1/2U | 1/2 | 3/8 | 0.47 | 1.61 | 0.93 | 1.38 | 1.46 | 0.94 | 0.43 | 0.83 | 11/16 | 74.3 | 7.0 | 17.1 | 0.92 |
| HVN4-1/2U | 1/2 | 1/2 | 0.59 | 1.61 | 0.93 | 1.38 | 1.52 | 0.94 | 0.43 | 0.83 | 7/8 | 97.1 | 7.0 | 16.8 | 0.91 |

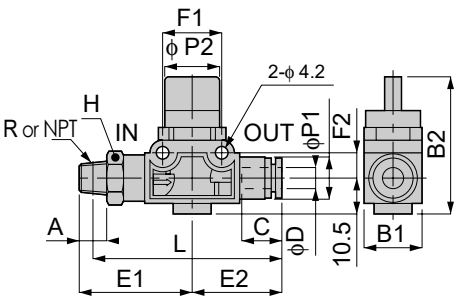

| Model | Tube O.D. ϕ D1 | R | A | B1 | B2 | L | ϕ P1 | ϕ P2 | Tube end C | E1 | E2 | H | F1 | F2 | Eff. area (mm^2) | Weight (g) | CAD file name |
|------------|---------------------|------|----|------|------|------|-----------|-----------|------------|------|------|----|----|----|-----------------------------|------------|---------------|
| HV01-6- | 6 | R1/8 | 8 | | | 55.9 | | | | 33.5 | | 14 | | | 8.3 | 34 | HV01-6_ |
| HV02-6- | | R1/4 | 11 | 17 | 40.5 | 56.8 | 12.5 | 16.5 | 17 | 36.5 | 26.4 | 14 | 18 | 8 | 8.5 | 40 | HV02-6_ |
| HV03-6- | | R3/8 | 12 | | | 58.3 | | | | | 38.3 | 17 | | | 8.2 | 53 | HV03-6_ |
| HV01-8- | 8 | R1/8 | 8 | | | 57.2 | | | | 33.5 | | 14 | | | 8.7 | 35 | HV01-8_ |
| HV02-8- | | R1/4 | 11 | 17 | 40.5 | 58.2 | 15 | 16.5 | 18.1 | 36.5 | 27.7 | 14 | 18 | 8 | 8.9 | 41 | HV02-8_ |
| HV03-8- | | R3/8 | 12 | | | 59.7 | | | | | 38.3 | 17 | | | 8.6 | 54 | HV03-8_ |
| HV02-10- | 10 | R1/4 | 11 | | | 68.7 | | | | 42.5 | | 17 | | | 16.6 | 62 | HV02-10_ |
| HV03-10- | | R3/8 | 12 | 21.7 | 41 | 69.4 | 17.5 | 19.5 | 20.2 | 43.5 | 32.2 | 17 | 24 | 11 | 16.9 | 71 | HV03-10_ |
| HV04-10- | | R1/2 | 15 | | | 70.5 | | | | | 46.5 | 21 | | | 16.5 | 93 | HV04-10_ |
| HV02-12- | 12 | R1/4 | 11 | | | 71.4 | | | | 42.5 | | 17 | | | 17 | 66 | HV02-12_ |
| HV03-12- | | R3/8 | 12 | 21.7 | 41 | 72.1 | 21 | 19.5 | 23.4 | 43.5 | 34.9 | 17 | 24 | 11 | 17.1 | 74 | HV03-12_ |
| HV04-12- | | R1/2 | 15 | | | 73.2 | | | | | 46.5 | 21 | | | 16.8 | 96 | HV04-12_ |
| HV01-1/4- | 1/4 | R1/8 | 8 | | | 55.9 | | | | 33.5 | | 14 | | | 8.7 | 34 | HV01-1_4_ |
| HV02-1/4- | | R1/4 | 11 | 17 | 40.5 | 56.8 | 12.5 | 16.5 | 17 | 36.5 | 26.4 | 14 | 18 | 8 | 8.4 | 40 | HV02-1_4_ |
| HV03-1/4- | | R3/8 | 12 | | | 58.3 | | | | | 38.3 | 17 | | | 8.5 | 53 | HV03-1_4_ |
| HV01-5/16- | 5/16 | R1/8 | 8 | | | 57.2 | | | | 33.5 | | 14 | | | 8.7 | 35 | HV01-5_16_ |
| HV02-5/16- | | R1/4 | 11 | 17 | 40.5 | 58.2 | 15 | 16.5 | 18.1 | 36.5 | 27.7 | 14 | 18 | 8 | 8.9 | 41 | HV02-5_16_ |
| HV03-5/16- | | R3/8 | 12 | | | 59.7 | | | | | 38.3 | 17 | | | 8.6 | 54 | HV03-5_16_ |
| HV02-3/8- | 3/8 | R1/4 | 11 | | | 68.7 | | | | 42.5 | | 17 | | | 16.5 | 63 | HV02-3_8_ |
| HV03-3/8- | | R3/8 | 12 | 21.7 | 41 | 69.4 | 17.5 | 19.5 | 20.2 | 43.5 | 32.2 | 17 | 24 | 11 | 16.8 | 71 | HV03-3_8_ |
| HV04-3/8- | | R1/2 | 15 | | | 70.5 | | | | | 46.5 | 21 | | | 16.6 | 93 | HV04-3_8_ |

❖ R thread is same as BSPT

| Model | Tube O.D. ϕ D1 | Tube O.D. ϕ D2 | B1 | B2 | ϕ P1 | ϕ P2 | ϕ P3 | Tube end C1 | Tube end C2 | E1 | E2 | F1 | F2 | Eff. area (mm^2) | Weight (g) | CAD file name |
|--------------|---------------------|---------------------|----|------|-----------|-----------|-----------|-------------|-------------|------|------|----|----|-----------------------------|------------|---------------|
| HV5/32-5/32- | 5/32 | 5/32 | 17 | 40.5 | 10 | 10 | 16.5 | 14.9 | 14.9 | 25.8 | 25.8 | 18 | 8 | 3.4 | 24 | HV4-4_ |
| HV3/16-3/16- | 3/16 | 3/16 | 17 | 40.5 | 12.5 | 12.5 | 16.5 | 17 | 17 | 26.4 | 26.4 | 18 | 8 | 5.1 | 25 | |
| HV1/4-3/16- | 1/4 | 3/16 | 17 | 40.5 | 12.5 | 12.5 | 16.5 | 17 | 17 | 26.4 | 26.4 | 18 | 8 | 5.1 | 25 | |
| HV1/4-1/4- | | 1/4 | | </ | | | | | | | | | | | | |

unit:inch

HV
Nipple Type

RoHS compliant

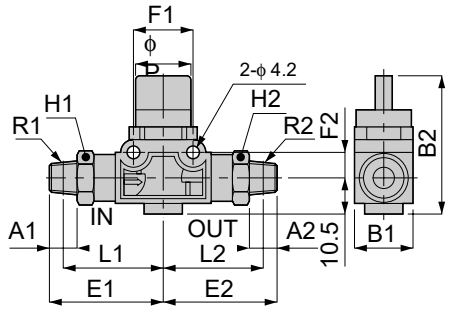

| MODEL | R1 | R2 | A1 | A2 | B2 | L1 | L2 | E1 | E2 | F1 | F2 | H1 | H2 | B1 | (g) | Orifice φmm | Eff. A. mm ² | Cv |
|----------|--------|--------|------|------|------|------|------|------|------|------|------|-------|-------|------|------|----------------|----------------------------|------|
| HVN1-N1U | 1/8NPT | 1/8NPT | 0.31 | 0.31 | 1.59 | 1.16 | 1.16 | 1.32 | 1.32 | 0.71 | 0.30 | 9/16 | 9/16 | 0.67 | 43.0 | 5.0 | 8.8 | 0.47 |
| HVN2-N1U | 1/4NPT | 1/8NPT | 0.43 | 0.31 | 1.59 | 1.16 | 1.16 | 1.44 | 1.32 | 0.71 | 0.30 | 9/16 | 9/16 | 0.67 | 48.9 | 5.0 | 9.0 | 0.48 |
| HVN2-N2U | 1/4NPT | 1/4NPT | 0.43 | 0.43 | 1.61 | 1.42 | 1.42 | 1.67 | 1.67 | 0.94 | 0.43 | 11/16 | 11/16 | 0.83 | 81.1 | 5.0 | 15.8 | 0.85 |
| HVN3-N2U | 3/8NPT | 1/4NPT | 0.47 | 0.43 | 1.61 | 1.42 | 1.42 | 1.71 | 1.67 | 0.94 | 0.43 | 11/16 | 11/16 | 0.83 | 89.5 | 5.0 | 15.6 | 0.84 |
| HVN3-N3U | 3/8NPT | 3/8NPT | 0.47 | 0.47 | 1.61 | 1.46 | 1.46 | 1.71 | 1.71 | 0.94 | 0.43 | 11/16 | 11/16 | 0.83 | 97.7 | 7.0 | 15.7 | 0.85 |

unit:mm

| MODEL | R1 | R2 | A1 | A2 | B1 | B2 | L1 | L2 | φP | E1 | E2 | H1 | H2 | F1 | F2 | Eff. A. (mm ²) | Weight (g) | CAD file name |
|----------|------|------|----|----|------|------|------|------|------|------|----------|----|----|----|----|-------------------------------|---------------|------------------|
| HV01-01- | R1/8 | R1/8 | 8 | 8 | 17 | 40.5 | 29.5 | 29.5 | 16.5 | 33.5 | 33.5 | 14 | 14 | 18 | 8 | 8.8 | 43 | HV01-01_ |
| HV02-01- | R1/4 | R1/8 | 11 | 8 | 17 | 40.5 | 30.5 | 29.5 | 16.5 | 36.5 | 33.5 | 14 | 14 | 18 | 8 | 9 | 49 | HV02-01_ |
| HV02-02- | | R1/4 | | 11 | 21.7 | 41 | 36.5 | 36.5 | 19.5 | 42.5 | 42.5 | 17 | 17 | 24 | 11 | 15.8 | 80 | HV02-02_ |
| HV03-02- | R3/8 | R1/4 | 12 | 11 | 21.7 | 41 | 37.2 | 36.5 | 19.5 | 43.5 | 42.5 | 17 | 17 | 24 | 11 | 15.6 | 88 | HV03-02_ |
| HV03-03- | | R3/8 | | 12 | 37.2 | 43.5 | 43.5 | 15.7 | | 96 | HV03-03_ | | | | | | | |

❖ R thread is same as BSPT

▲ Detailed Safety Instructions

Before using the PISCO device, be sure to read the "Safety Instructions", "Common Safety Instructions for Products Listed in This Manual" and "Common Safety Instructions for Change Series Valves".

▲ Caution

- When operating the cap lever, turn it 90 degrees completely until it stops. Inadequate turning may result in poor conduction or low flow rate due to faulty switching.
- Distinguish between the two-directional and the three-directional control valve by checking the marking ② or ③ on the top surface of the cap lever.
- For use with negative pressures, provide a vacuum filter on the suction side. Otherwise dust sucked in may cause malfunction.

■ Identification between Three-directional control valve and Two-directional control valve Check the marking on the lever cap

③: Three-directional control valve - 3-way

②: Two-directional control valve - 2-way

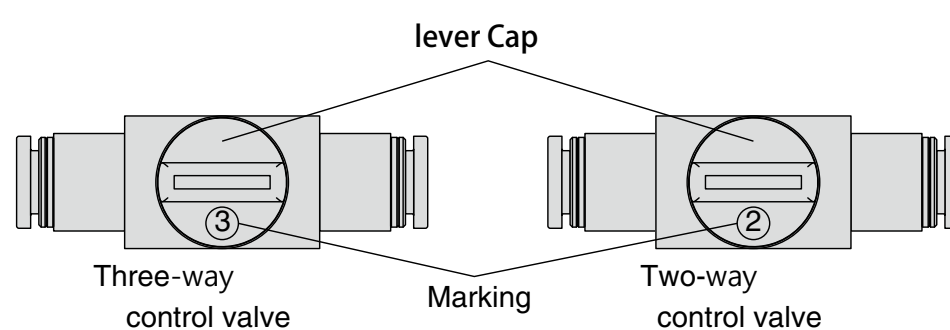

■ Cap lever operation

1. Open the valve

To open the valve, turn the cap lever 90 degrees until it stops.

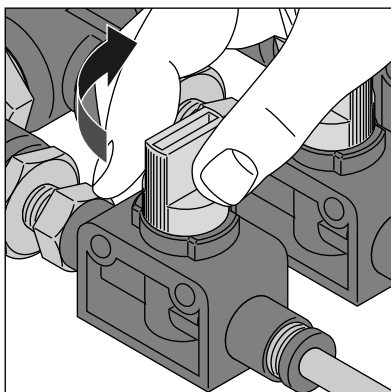

2. Close the valve

To close the valve, turn the cap lever 90 degrees counterclockwise until it stops.

As for three-way valve, the residual pressure in outlet side is released from the gap between the lever cap and the body when turning it off.

