

Features

- Single to 12 stations
- Variety of port sizes
- Compact
- Precision machined
- Anodized aluminum for corrosion resistance

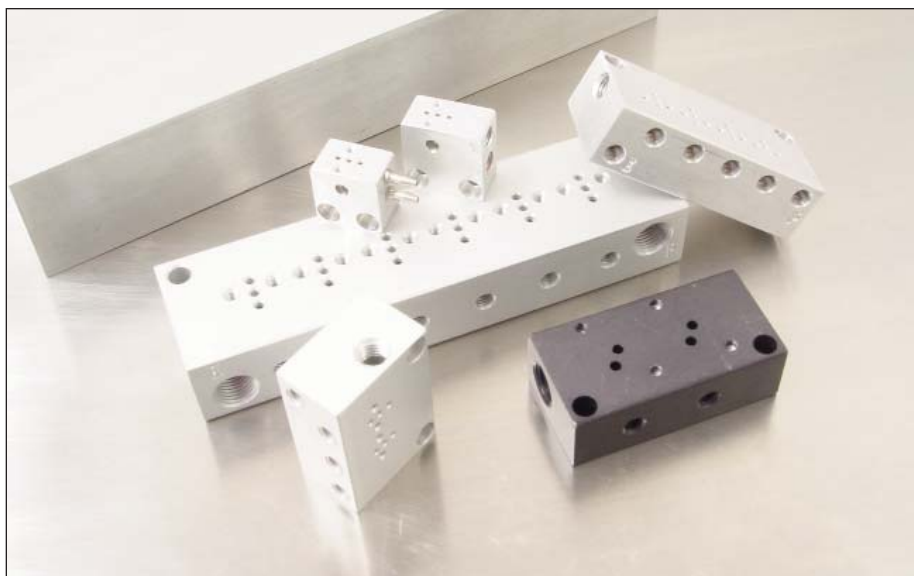

Manifolds & Single Bases

For use with Pneumadyne Solenoid Valves

Pneumadyne manifolds are a compact, cost effective solution for mounting multiple [solenoid valves](#). Single to 12-station manifolds are available with 10-32 (F), M5 (F), 1/8 NPT (F) or 1/4 NPT (F) threads. For added versatility, the single bases also feature 5/32 push-to-connect.

All manifolds are anodized for corrosion resistance. Cover plates are available to conceal unused stations and block the valve supply port.

- [Push-to-connect fittings available](#) for 1/8" and 5/32" OD tubing. (For use with multiple station manifolds)



Manifolds are designed for use with specific valves. Be sure to select from the correct product grouping when ordering manifolds and bases for use with solenoid valves.

Performance Data

Temperature Range	Operating Pressure
-10°F to 200°F -23°C to 93°C	Determined by Valve

Materials

Aluminum/ Anodize

Port Options

Manifold	Single Station	Multiple Station	
		Pressure	Output
10 mm	● M5 ● 10-32 ● 5/32 PI	● 10-32 ● M5	● 10-32 ● M5
15 mm	● M5 ● 10-32 ● 5/32 PI	1/8 NPT	10-32
System 6	10-32	1/8 NPT	10-32
System 8	1/8 NPT	1/4 NPT	10-32

Fitting Recommendations

Standard 1/4 hex O-ring fittings are recommended for use with standard threaded manifolds and single bases. Please refer to Pneumadyne's full line catalog for fitting information.

Fittings must be installed prior to mounting valves.

15 mm Manifolds

Part Number	Stations	A	B
MSV15-2	2	1.74	2.13
MSV15-4	4	2.99	3.38
MSV15-6	6	4.24	4.63
MSV15-8	8	5.49	5.88
MSV15-10	10	6.74	7.13
MSV15-12	12	7.99	8.38
MSV15-2-M5	2	1.74	2.13
MSV15-4-M5	4	2.99	3.38
MSV15-6-M5	6	4.24	4.63
MSV15-8-M5	8	5.49	5.88
MSV15-10-M5	10	6.74	7.13
MSV15-12-M5	12	7.99	8.38

Normally closed and normally open 15 mm valves can be mounted on the same manifold

15 mm Bases

Part Number	Stations	Lgth	width	hgt
MSV15-1	1	1.25	.63	.66
MSV15-1-M5	1	1.25	.63	.66
MSV15-1-M5P	1	1.25	.63	.88
MSV15-1P	1	1.25	.63	.88
MSV15-1-156	1	1.25	.63	.88



Solenoid single bases and multiple station manifolds feature a clear anodic coating which provides corrosion and wear resistance

We design custom products to meet your application needs

15 mm Manifold

Multiple Station
1/8 NPT Pressure and Exhaust ports
10-32 Output ports

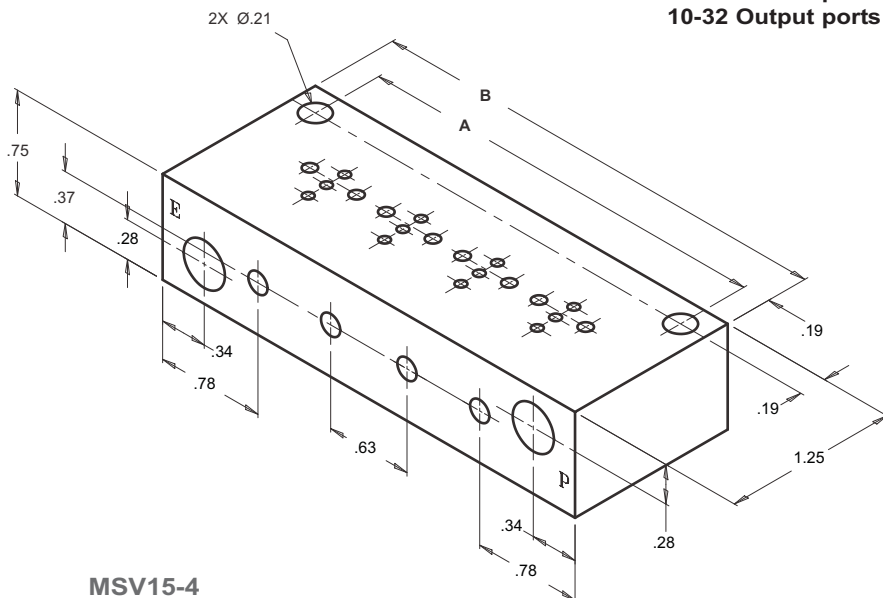

15 mm Single Bases

Single Station

MSV15-1 10-32
MSV15-1-M5 M5 ports

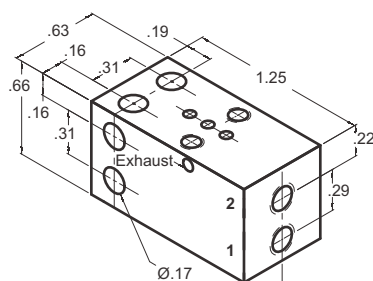

● For use with 1/4 hex fittings

MSV15-1P 10-32 ports
MSV15-1-M5P M5 ports

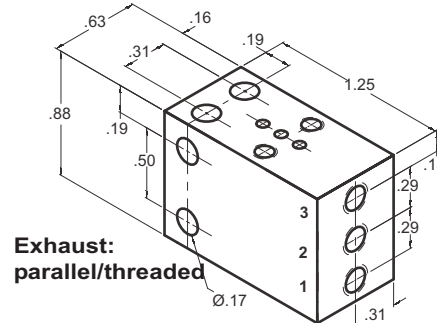

● For use with 1/4 hex fittings

MSV15-1-156
5/32 push-to-connect ports

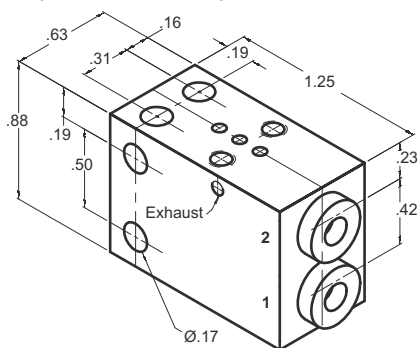

* Single base mount: Valve hangs over ports ([pg. 124 lower photo](#))

We design custom products to meet your application needs

System 6 Manifold

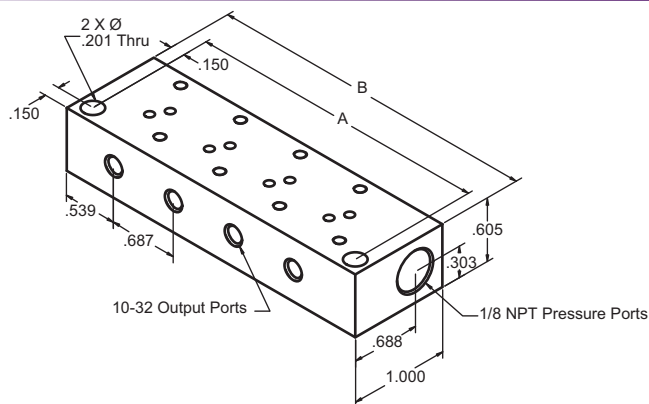

System 6 Base

MSV6-1

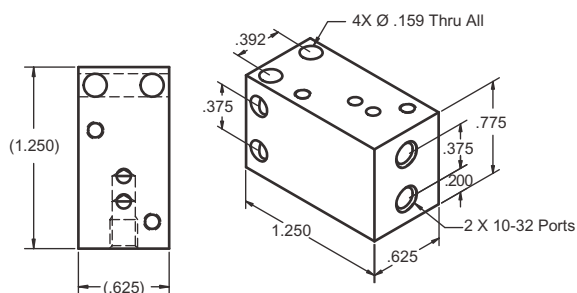

System 8 Manifold

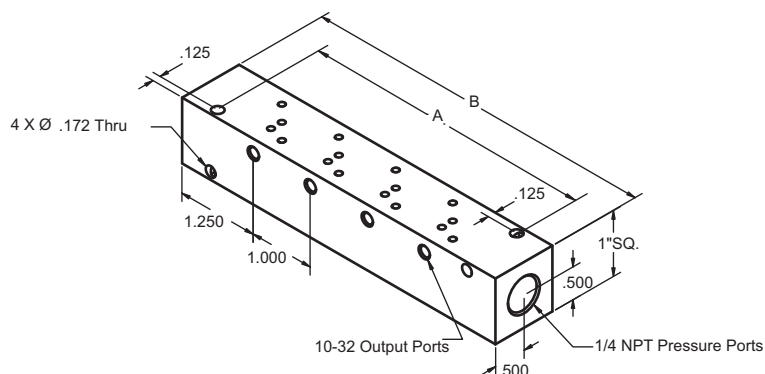

System 8 Base

MSV8-1

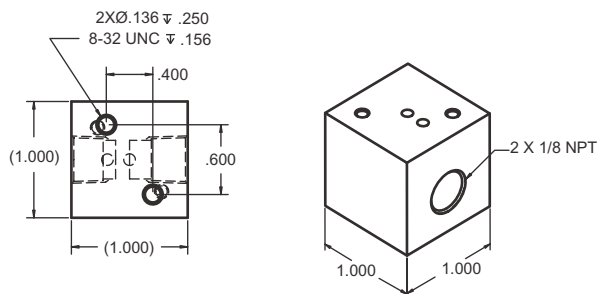

System 6 Manifolds

<i>Part Number</i>	<i>Stations</i>	<i>A</i>	<i>B</i>
MSV6-1	1	<i>See Drawing</i>	
MSV6-2	2	1.64	1.94
MSV6-3	3	2.33	2.63
MSV6-4	4	3.01	3.31
MSV6-5	5	3.70	4.00



System 6 parallel ported single station manifold

System 8 Manifolds

Part Number	Stations	A	B
MSV8-1	1	<i>See Drawing</i>	
MSV8-2	2	2.50	3.50
MSV8-3	3	3.50	4.50
MSV8-4	4	4.50	5.50
MSV8-5	5	5.50	6.50
MSV8-6	6	6.50	7.50
MSV8-7	7	7.50	8.50
MSV8-8	8	8.50	9.50
MSV8-9	9	9.50	10.50
MSV8-10	10	10.50	11.50

Ordering Information

- To order standard product refer to Product Information listing.
- Contact factory for custom colors.
- Cover Plates available.
- Solenoid valves sold separately. Refer to Solenoid Valve section for ordering information.

Features

- Controls cylinder extension and retraction
- Allows rapid cylinder return
- 3-Way Normally Closed
- Quick Exhaust & Needle Valve options
- Male pipe thread for direct mount to single acting spring return cylinders



Cylinder Control Bases

When used in conjunction with Pneumadyne's 15 mm Solenoid Valves, these precision machined bases are an ideal choice for applications requiring controlled movement of single-acting spring return cylinders. Configurations featuring a quick exhaust and/or needle valve are available to easily control cylinder extension and retraction speeds. These precision machined valves were designed for use with [Pneumadyne's 15 mm Solenoid Valves \(sold separately\)](#).

Materials

Brass/Electroless Nickel,
Aluminum/Anodize, Stainless
Steel, Buna-N, Urethane

Performance Data

Temperature Range		Operating Pressure		Media	
-20° to 160° F		0 to 125 psi		Air	
Product	Max. Flow (scfm)		C _v	Fill Time sec/in3 0-90 psi	Exhaust Time sec/ in3 100-10 psi
	50 psi	125 psi			
CCV-F1-1	2.1	4.6	.045	.070	.120
CCV-F1-2	1.8	4.1	.045	.070	.012
CCV-F1-3	2.1	4.6	.045	.070	.012
CCV-F1-4	1.8	4.1	.045	.070	.120
CCV-44-4	1.8	4.1	.045	.070	.120

Cv per ANSI / (NFPA) T3.21.3

Operator: 15 mm 3WNC solenoid valve Ø1.6 mm orifice (sold separately)

Five configurations are available to accommodate cylinder extension and retraction requirements:

CCV-F1-1 features a 10-32 (F) input port and 1/8 NPT output port. Input pressure determines the rate of cylinder extension while the cylinder's spring controls rod retraction.

CCV-F1-2 offers the combination of a Needle Valve and Quick Exhaust providing controlled cylinder movement in both directions. A built-in Needle Valve in the input port, 10-32 (F), controls cylinder extension while the 1/8 NPT Quick Exhaust in the output port allows rapid cylinder return.

CCV-F1-3 provides a 10-32 (F) input port and built-in Quick Exhaust with 1/8 NPT output port. Input pressure controls the cylinder extension and the Quick Exhaust allows rapid cylinder return.

CCV-F1-4 features a built-in Needle Valve in the input port, 10-32 (F), for controlled cylinder extension. The cylinder's spring controls rod retraction.

CCV-44-4 features 1/8 NPT (F) input and output ports. A built-in Needle Valve in the input port provides controlled cylinder extension while the cylinder's spring controls rod retraction.

Cylinder Control Valve

CCV-F1-1

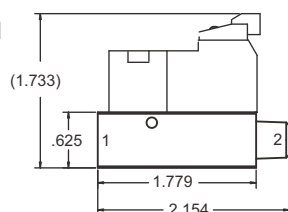

CCV-F1-4

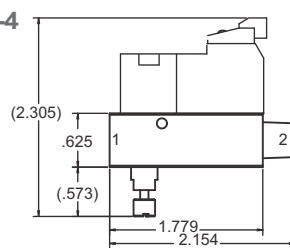

CCV-F1-2

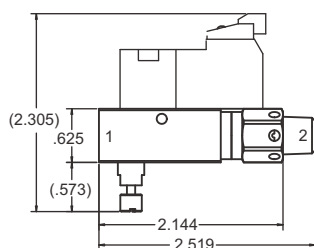

CCV-44-4

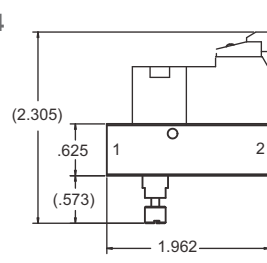

CCV-F1-3

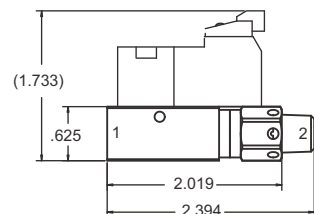

Cylinder Control Valve

Max. Flow vs. Input Pressure

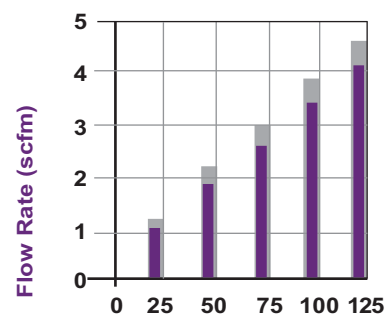

Input Pressure (psi)

CCV-F1-2
CCV-F1-4, CCV-44-4
CCV-F1-1 & CCV-F1-3

Cylinder Control Valve

Turns vs. Pressure for Needle Valves

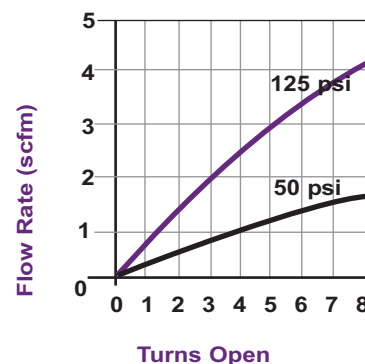

Function

Applying an electrical signal to the solenoid results in the controlled rod movement determined by the Cylinder Control Base.

Product Information

Part Number	Input	Output
CCV-F1-1	10-32 (F)	1/8 NPT
CCV-F1-2	10-32 (F) Needle Valve	1/8 NPT Quick Exhaust
CCV-F1-3	10-32 (F)	1/8 NPT Quick Exhaust
CCV-F1-4	10-32 (F) Needle Valve	1/8 NPT
CCV-44-4	1/8 NPT (F) Needle Valve	1/8 NPT (F)

Ordering Information

- To order standard product refer to Product Information listing.
- 15 mm Solenoid Valves sold separately.
- Contact factory for custom porting configurations.

Ideal for controlling the movement of single-acting spring return cylinders