

Features

- Mounting versatility- inline connection or panel mount
- Time saving- allows disconnection while system is pressurized
- Optional dress plate for finished look
- Ideal for medical and dental applications



Micro Coupler

Micro couplers are used in systems where rapid and repeated connecting and disconnecting of fluid conductors is required. They are ideal for use on test equipment, patch systems, quick set-ups of machines, jigs and fixtures. Micro couplers offer an easy solution, without the use of tools, for the connection and disconnection of single tubing.

The **plug connector** has a specially designed electroless nickel plated brass body with a Buna-N O-ring retained opposite the barb. This quality O-ring ensures a leakproof seal when connected to a socket component. The plug connector body is secured within the plug connector nut by a c-clip enabling the barb to float and rotate thus accommodating the natural twist of the tubing and providing for easier installation.

The compact **straight-thru socket connector** is used on systems where unrestricted flow is required. When coupled with the plug connector the overall length is only 5/8" - ideal for limited space applications.

Performance Data

Product	Temperature Range	Operating Pressure	Media	Cv	Flow Rate (scfm)	
					50 psi	125 psi
Straight-thru	-20° to 160° F -28° to 71° C	0 to 125 psi	Fluids Compatible w/ Materials	.15	4.8	10
Valved				.13	4.2	9

The unique design of the **in-line socket connector with shut-off valve** ensures maximum flow and a reliable seal. When connected, flow is directed into a side port on the stem and out the output port. When disconnected a spring slides the stem forward thereby sealing the valve seat and stopping the flow. A Buna-N O-ring retained near the end of the valve stem ensures a reliable, leakproof seal.

The **bulkhead socket connector** with shut-off valve provides the durability and convenience often required for use on test equipment. This miniature coupler (1.53 OAL) can be mounted on a control panel via the 15/32-32 thread, two (2) jam nuts and a lock washer are provided to secure the component in place.

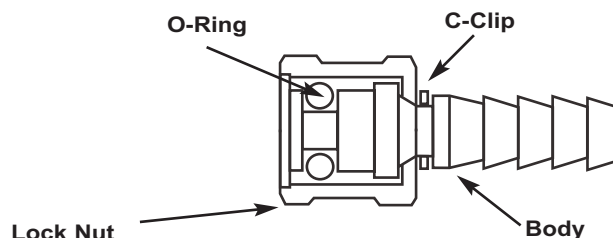

Micro Coupler

Socket Connectors

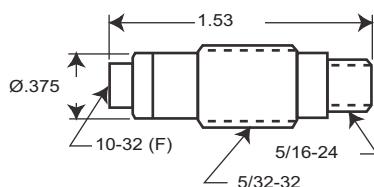

PMCBH-*

Valved Bulkhead Socket

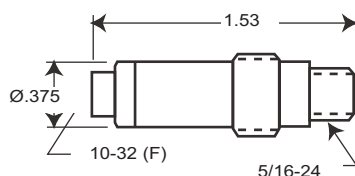

PMCIL-*

Valved Inline Socket

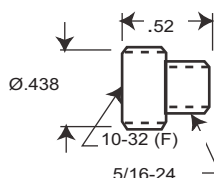

PMCM-*

Straight-thru Socket

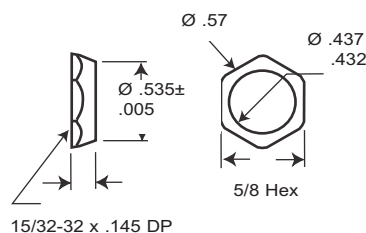

DP-22

DP-11

Plug Connectors

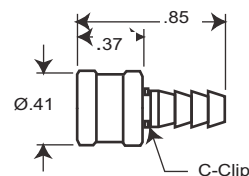

PMC-110

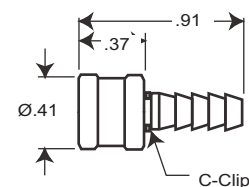

PMC-170

Product Information

Part Number	Description	Part Number	Description
Bulkhead Socket, valved		Inline Socket, straight-thru	
PMCBH-10/32	10-32 (F)	PMCM-10/32	10-32 (F)
PMCBH-062	062 barb valve assembly	PMCM-062	062 barb assembly
PMCBH-110	110 barb valve assembly	PMCM-110	110 barb assembly
PMCBH-170	170 barb valve assembly	PMCM-170	170 barb assembly
Inline Socket, valved		Plug Connector	
PMCIL-10/32	10-32 (F)	PMC-110	Plug: 110 barb
PMCIL-062	062 barb valve assembly	PMC-170	Plug: 170 barb
PMCIL-110	110 barb valve assembly	Panel Mount Dress Plate	
PMCIL-170	170 barb valve assembly	DP-11	Black Anodized
		DP-22	Electroless Nickel

Ordering Information

The micro coupler socket and plug connectors are sold separately and sockets are available with standard fitting options.

The electroless nickel plated brass barbed ends are assembled into the 10-32 (F) port of the micro coupler socket.

Materials

Plug Connector: Brass, Electroless Nickel Plated, Zinc Dichromate

O-rings: Buna-N; other materials available- contact factory

Socket Connector: Brass, Electroless Nickel Plated

Dress Plate: Aluminum, Electroless Nickel Plating, Black Anodized