



Back Flow Preventing Valve with Push-In Fitting **Check Valve Series**

- *Back Flow Prevention. Keep Pressure in Outlet Side.*
- *Ideal for Vacuum Retention or Low-Pressure Application.*
- *Body of in-line type is made of aluminum.*
- *Low-cost and Lightweight Resin Type available.*

*Visit the site for the dimensions and the details about
Low Cracking Pressure Check Valve
SUS304 PP Water Use Check Valve*

Model Designation (Example)

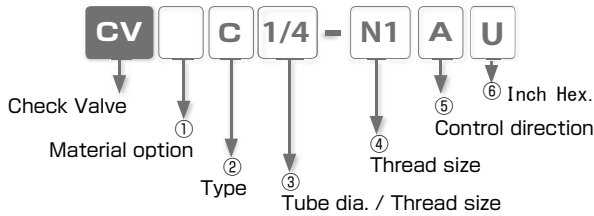

① Material option

No code : Metal type

P : Resin type (Only available for CVC and CVU with tube dia. 4/6/8mm and CVF Rc1/8 and Rc1/4)

※ . Material of Bush type (CVPF) body is metal and Poppet is resin.

② Type

Code	Type	Code	Type	Code	Type	Code	Type
C	Straight	U	In-Line Straight	G	In-Line Reducer	F	Bush

③ Tube dia. / Thread size

Connection	Tube dia.					Taper pipe thread (Male)			
Code	5/32	1/4	5/16	3/8	1/2	N1	N2	N3	N4
Size (inch)	5/32"	1/4"	5/16"	3/8"	1/2"	1/8NPT	1/4NPT	3/8NPT	1/2NPT

Code	4	6	8	10	12	01	02	03	04
Size (mm)	ø4	ø6	ø8	ø10	ø12	R1/8	R1/4	R3/8	R1/2

※ R thread is same as BSPT

④ Thread size(※ . Female threads are for CVF, CVPF types only)

Connection	Tube dia.					UNF thread	Taper pipe thread (Male or Female)			
Code	5/32	1/4	5/16	3/8	1/2	U10	N1	N2	N3	N4
Size (inch)	5/32"	1/4"	5/16"	3/8"	1/2"	10-32UNF	1/8NPT	1/4NPT	3/8NPT	1/2NPT

Metric

Code	4	6	8	10	12	M5	M6	01	02	03	04
Size (mm)	ø4	ø6	ø8	ø10	ø12	M5×0.8	M6 × 1	R1/8	R1/4	R3/8	R1/2
								Rc1/8	Rc1/4	Rc3/8	Rc1/2

※ R thread is same as BSPT

⑤ Control direction (※ . No entry for In-line straight type "U")

Code	A	B
Control direction	Inlet on male thread	Outlet on male thread

⑥ Wrench Size

U : inch wrench spec. (NPT and UNF thread), not applied to CVPC models

No Code : metric wrench spec. (all CVPC models and metric thread models)

Specifications

Fluid medium	Air
Operating pressure range	-29.5 inHg ~130psi (-0.1 ~ 0.9 MPa)
Opening pressure	1.45psi (0.01MPa)
Max. vacuum	-29.5 in. Hg (-100kPa)
Operating temp. range	32 ~ 140°F (0 ~ 60°C) (no freezing)

※ Opening pressure is the initial pressure on the secondary side when the pressure is applied from free flow side.

Construction (Metal type straight: CVC)



Symbol

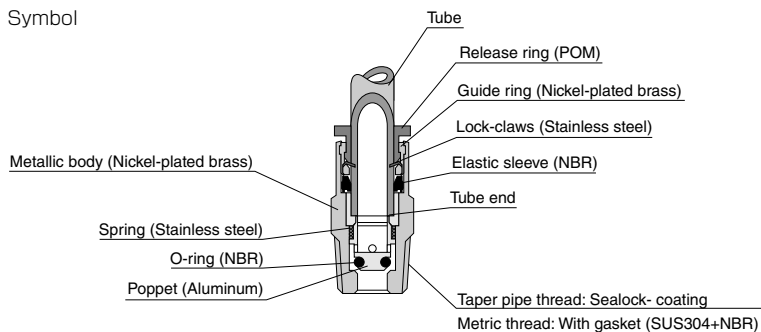

Construction (Resin type straight: CVPC)



Symbol

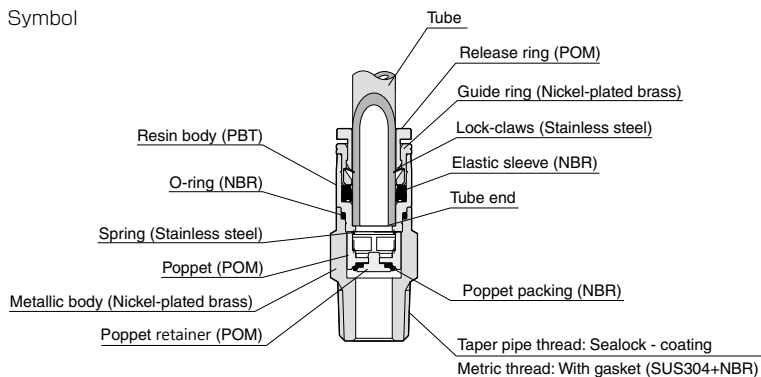

Check Valve Series

CVC Straight

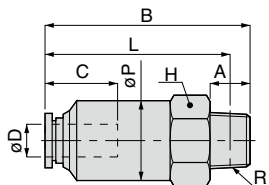

Unified or Metric thread type

❖ NPT, UNF thread

Unit : inch

Model code	Tube O.D. øD	R	A	B	L	øP	Tube end C	Hex. H	CAD file name
CVC5/32-U10□U	5/32	10-32 UNF	0.14	1.10	0.96	0.31	0.43	5/16	CVC5_32-U10_U
CVC5/32-N1□U		1/8 NPT	0.31	0.94	0.79	0.35	0.43	7/16	CVC5_32-N1_U
CVC1/4-N1□U	1/4	1/8 NPT	0.31	1.14	0.98	0.39	0.47	7/16	CVC1_4-N1_U
CVC1/4-N2□U		1/4 NPT	0.43	1.14	0.91	0.47	0.47	9/16	CVC1_4-N2_U
CVC5/16-N1□U	5/16	1/8 NPT	0.31	1.40	1.24	0.53	0.73	9/16	CVC5_16-N1_U
CVC5/16-N2□U		1/4 NPT	0.43	1.56	1.32	0.53	0.73	9/16	CVC5_16-N2_U
CVC3/8-N3 □U*	1/2	3/8 NPT	0.47	2.44	2.19	0.98	0.83	1	CVC3_8-N3_U
CVC3/8-N4 □U*		1/2 NPT	0.59	2.74	2.38	1.10	0.83	1 1/8	CVC3_8-N4_U

Unit : mm

Model code	Tube O.D. øD	R	A	B	L	øP	Tube end C	Hex. H	Effective area (mm ²)	Weight (g)	CAD file name
CVC4-M5□	4	M5 × 0.8	3	27.8	24.8	8	10.9	8	2.5	7.2	CVC4-M5_
CVC4-M6□		M6 × 1	3.9	28.8	24.9				7.4	7.4	CVC4-M6_
CVC4-01□		R1/8	8	23.9	19.9				2.7	11	CVC4-01_
CVC6-01□	6	R1/8	8	29	25	10	11.7	10	6.8	11	CVC6-01_
CVC6-02□		R1/4	11		23			14	6.8	23	CVC6-02_
CVC8-01□	8	R1/8	8	35.5	31.5	13.5	18.2	14	6.8	22	CVC8-01_
CVC8-02□		R1/4	11	39.2	33.2				15.5	24	CVC8-02_
CVC10-03□*	10	R3/8	12	61.7	55.4	25	20.7	24	35	47	CVC10-03_
CVC10-04□*		R1/2	15	68.2	60	28		27	39	65	CVC10-04_
CVC12-03□*	12	R3/8	12	64.3	58	25	23.3	24	50	50	CVC12-03_
CVC12-04□*		R1/2	15	70.8	62.6	28		27	53	69	CVC12-04_

*Material for metallic body is aluminum.

※ 1. "L" is a reference value for height dimension after tightening taper thread.

※ 2. □ in Model code / Replaced with "A" for Inlet on male thread, "B" for Outlet on male thread

**CVPC Straight (Resin type)**

RoHS compliant

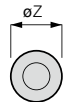
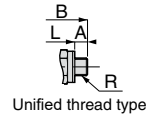
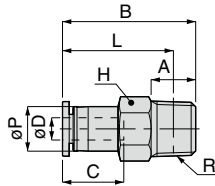
Release ring
Standard type
øD : 5/16"Release ring
Mini type
øD : 5/32", 1/4"

Unit : mm

Model code	Tube O.D. øD	R	A	B	L	øP	Tube end C	Hex. H	X	Y	øZ	Effective area (mm ²)	Weight (g)
CVPC5/32-U10□	5/32"	10-32UNF	3	24.2	21.2	9	11	8	9.8	7.8	—	2.6	4.3
CVPC5/32-N1□		1/8NPT	8	23.9	19.8			12				2.7	9.8
CVPC1/4-N1□	1/4"	1/8NPT	8	30.7	26.6	11	11.4	12	11.8	9.8	—	7.2	12
CVPC1/4-N2□		1/4NPT	11	28	22.2			14				7.3	17
CVPC5/16-N1□	5/16"	1/8NPT	8	35.5	31.4	14	18.1	14	—	—	13.8	7.3	20

※ 1. "L" is a reference value for height dimension after tightening taper thread.

※ 2. □ in Model code / Replaced with "A" for Inlet on male thread, "B" for Outlet on male thread

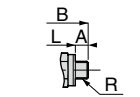
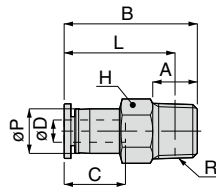
Release ring
Mini type
øD : 4, 6

Metric thread type

Unit : mm

Model code	Tube O.D. øD	R	A	B	L	øP	Tube end C	Hex. H	X	Y	Effective area (mm ²)	Weight (g)	CAD file name
CVPC4-M5□	4	M5 × 0.8	3	24.2	21.2	9	11	8	9.8	7.8	2.6	4.3	CVPC4-M5_
CVPC4-M6□		M6 × 1	4	25.2				10			2.7	4.6	CVPC4-M6_
CVPC4-01□		R1/8	8	23.9				10			7.2	9.0	CVPC4-01_
CVPC6-01□	6	R1/8	8	30.5	26.5	11	11.4	10	11.8	9.8	7.2	9.0	CVPC6-01_
CVPC6-02□		R1/4	11	27.8	21.8			14			7.3	16.1	CVPC6-02_
CVPC8-01□	8	R1/8	8	35.5	31.5	14	18.1	14	—	—	7.3	19.3	CVPC8-01_
CVPC8-02□		R1/4	11	39.5	33.5			14			14.5	21.7	CVPC8-02_

※ 1. "L" is a reference value for height dimension after tightening taper thread.

※ 2. □ in Model code / Replaced with "A" for Inlet on male thread, "B" for Outlet on male thread

CVU In-Line Straight

RoHS compliant

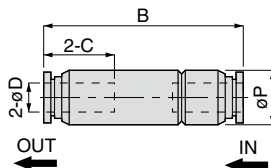

Unit : inch

Model code	Tube O.D. øD	B	øP	Tube end C	CAD file name
CVU5/32-5/32	5/32	1.34	0.35	0.43	CVU5_32-5_32
CVU1/4-1/4	1/4	1.52	0.47	0.47	CVU1_4-1_4
CVU5/16-5/16	5/16	2.19	0.59	0.73	CVC5_16-5_16
CVU3/8-3/8*	3/8	3.25	0.98	0.83	CVC3_8-3_8
CVU1/2-1/2*	1/2	3.44	0.98	0.93	CVC1_2-1_2

※ Material of the body of small models from 5/32" to 5/16" is anodized aluminum. For the larger sizes marked with * are made of aluminum.

Unit : mm

Model code	Tube O.D. øD	B	øP	Tube end C	Effective area (mm ²)	Weight (g)	CAD file name
CVU4-4	4	33.6	9	10.9	2.7	5.3	CVU4-4
CVU6-6	6	38.2	12	11.7	6	10	CVU6-6
CVU8-8	8	54.9	15	18.2	13.5	21	CVU8-8
CVU10-10*	10	73.4	25	20.7	32	63	CVU10-10
CVU12-12*	12	78.6	25	23.3	46	69	CVU12-12

※ Material of the body upto 8mm is anodized aluminum. For the larger sizes marked with * are made of aluminum.

CVPU In-Line Straight (Resin type)

RoHS compliant

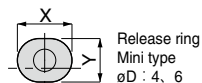
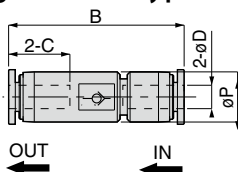

Release ring
Mini type
øD : 4、6

Unit : mm

Model code	Tube O.D. øD	B	øP	Tube end C	X	Y	Effective area (mm ²)	Weight (g)	CAD file name
CVPU4-4	4	31.5	9	11	9.8	7.8	2.9	3.7	CVPU4-4
CVPU6-6	6	34	11	11.6	11.8	9.8	7.5	5.4	CVPU6-6
CVPU8-8	8	47.3	15	18.1	—	—	15.5	13.0	CVPU8-8

- ❖ Inexpensive resin body 5/32, 5/16 1/4, 3/8, 1/2 inch O.D. in-line check valve is available.
See the site of Low cracking type of In-line check valve (CVLU)



CVG In-Line Reducer

RoHS compliant

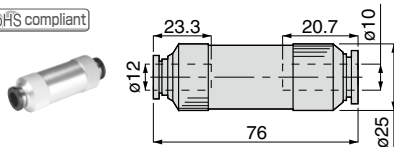

Model code	Effective area (mm ²)	Weight (g)	CAD file name
CVG12-10□	36	65	CVG12-10

※ Material of metallic body is aluminum.

※ □ in Model code / Replaced with "A" for Inlet on ø 12mm, "B" for Outlet on ø 12mm. Air flow direction as below

A: ø 12 → ø 10mm

B: ø 10 → ø 12mm

CVF Bush

RoHS compliant

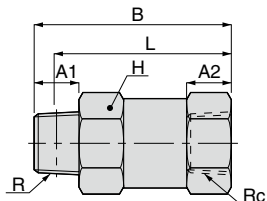

❖ NPT thread

Unit : inch

Model code	R	Rc	A1	B	L	Hex. H	CAD file name
CVFN1-N1□U	1/8NPT	1/8NPT	0.31	1.04	0.89	9/16	CVFN1-N1_U
CVFN2-N2□U	1/4NPT	1/4NPT	0.43	1.30	1.06	11/16	CVFN2-N2_U
CVFN3-N3□U *	3/8NPT	3/8NPT	0.47	2.05	1.79	1	CVFN3-N3_U
CVFN4-N4□U *	1/2NPT	1/2NPT	0.59	2.44	2.19	1 1/8	CVFN4-N4_U

Unit : mm

Model code	R	Rc	A1	A2	B	L	Hex. H	Effective area (mm ²)	Weight (g)	CAD file name
CVF01-01□	R1/8	Rc1/8	8	8.5	26.3	22.3	14	6	22	CVF01-01_U
CVF02-02□	R1/4	Rc1/4	11	11	33	27	17	14.5	37	CVF02-02_U
CVF03-03□*	R3/8	Rc3/8	12	12	52	45.7	24	52	38	CVF03-03_U
CVF04-04□*	R1/2	Rc1/2	15	15	62	53.8	27	78	57	CVF04-04_U

*Material for metallic body is aluminum.

※ 1. "L" is a reference value for height dimension after tightening taper thread.

※ 2. □ in Model code / Replaced with "A" for Inlet on male thread, "B" for Outlet on male thread

CVPF Bush (Resin type)

RoHS compliant

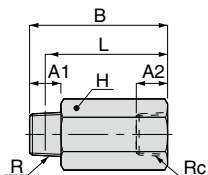

Unit : mm

Model code	R	Rc	A1	A2	B	L	Hex. H	Effective area (mm ²)	Weight (g)	CAD file name
CVPFN1-N1□	1/8NPT	1/8NPT	8	7	27.7	23.6	14	7	24	-
CVPF01-01□	R1/8	Rc1/8	8	6.5	27.7	23.7	14	7	23.9	CVPF01-01_U
CVPF02-02□	R1/4	Rc1/4	11	9.5	34.6	28.6	17	14.3	39.2	CVPF02-02_U

※ 1. "L" is a reference value for height dimension after tightening taper thread.

※ 2. □ in Model code / Replaced with "A" for Inlet on male thread, "B" for Outlet on male thread.



In-Line Straight Low Cracking Pressure

RoHS compliant

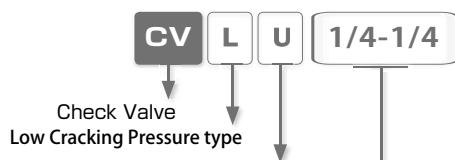

① Tube dia.

Union type only

① Tube dia.

Code	5/32-5/32	1/4-1/4	5/16-5/16	3/8-3/8	1/2-1/2	4-4	6-6	8-8	10-10	12-12
Tube dia.	5/32"	1/4"	5/16"	3/8"	1/2"	ø4mm	ø6mm	ø8mm	ø10mm	ø12mm

Specifications

Fluid medium	Air
Operating pressure range	-29.5 inHg ~ 145psi (-0.1 ~ 1.0MPa)
Opening pressure	0.725psi (0.005MPa)
Min. opening differential pressure	1.45psi (0.01MPa)
Operating temp. range	32 ~ 140°F (0 ~ 60°C) (no freezing)

※ Opening pressure is the initial pressure on the secondary side when the pressure is applied from free flow side.

※ See the website of Low Cracking Pressure Check Valve as to the dimensions and details



In-Line Straight Low Cracking Pressure PP series

(Polypropylene body + SUS304 metal parts for clean environment)

RoHS compliant

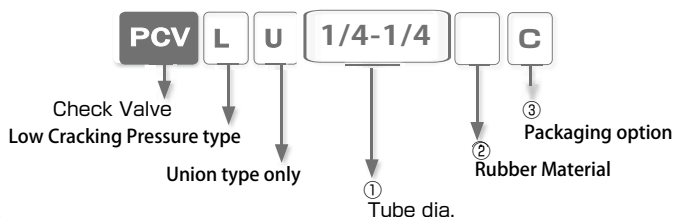

① Tube dia.

① Tube dia.

Code	5/32-5/32	1/4-1/4	5/16-5/16	3/8-3/8	1/2-1/2	4-4	6-6	8-8	10-10	12-12
Tube dia.	5/32"	1/4"	5/16"	3/8"	1/2"	ø4mm	ø6mm	ø8mm	ø10mm	ø12mm

② Rubber material

Code	No code	-F	-N
Material	EPDM	FKM	NBR

*The material of the valve packing is FKM

③ Packaging option

-C: Clean-room package

No code: Standard package

Specifications

Fluid medium	Air, Water, Other chemical (conditional)
Operating pressure range	-29.5 inHg ~ 145psi (-0.1 ~ 1.0MPa)
Opening pressure	0.725psi (0.005MPa)
Min. opening differential pressure	1.45psi (0.01MPa)
Operating temp. range	32 ~ 140°F (0 ~ 60°C) (no freezing)

※ Opening pressure is the initial pressure on the secondary side when the pressure is applied from free flow side.

※ See the website of SUS304 PP Water Use Check Valve as to the dimensions and details

Standard Size List

Connection: Thread ⇔ Tube

- Metallic body

Type	Thread size	Tube O.D. (inch)				
		5/32	1/4	5/16	3/8	1/2
CVCI Straight	10-32UNF	●				
NPT, UNF thread	1/8NPT	●	●	●		
	1/4NPT		●	●		
	3/8NPT				●	●
	1/2NPT					●

Type	Thread size	Tube O.D. (mm)				
		4	6	8	10	12
CVCI Straight	M5 × 0.8	●				
Metric, R or BSPT thread	M6 × 1	●				
	R1/8		●	●		
	R1/4		●	●		
	R3/8				●	●
	R1/2				●	●

- Plastic main body

Type	Thread size	Tube O.D. (inch)		
		5/32	1/4	5/16
CVPI Straight	10-32UNF	●		
NPT, UNF thread	1/8NPT	●	●	
	1/4NPT		●	●

Type	Thread size	Tube O.D. (mm)		
		4	6	8
CVPI Straight	M5 × 0.8	●		
Metric, R or BSPT thread	M6 × 1	●		
	R1/8	●	●	●
	R1/4		●	●

Connection: Tube ⇔ Tube (Equal dia.)

Type	Tube O.D. (Inch)				
	5/32	1/4	5/16	3/8	1/2
CVU In-Line Straight	●	●	●	●	●
CVLU In-Line Straight Low Cracking	●	●	●	●	●
PCVLU In-Line Straight PP + SUS304	●	●	●	●	●

Type	Tube O.D. (mm)				
	4	6	8	10	12
CVU Union Straight	●	●	●	●	●
CVPU Union Straight	●	●	●	●	●
CVLU In-Line Straight Low Cracking	●	●	●	●	●
PCVLU In-Line Straight PP + SUS304	●	●	●	●	●

Connection: Tube ⇔ Tube (Unequal dia.)

Type	Tube O.D.1 (mm)	Tube O.D.2(mm)
		10
CVS Unequal Union Straight	12	●

Connection: Male thread ⇔ Female thread

Type	Thread size			
	1/8NPT	1/4NPT	3/8NPT	1/2NPT
CVF Bush (NPT)	●	●	●	●
CVPF Bush (NPT)	●			

Type	Thread size			
	R1/8	R1/4	R3/8	R1/2
CVF Bush (R or BSPT)	●	●	●	●
CVPF Bush (R or BSPT)	●	●		



Detailed Safety Instructions

Before using PISCO products, be sure to read "Safety Instructions" and "Safety Instruction Manual".

Warning

1. Frequent switching may generate heat and cause a danger of getting burnt. Contact us in case of using Check Valve with frequent switching.

Caution

1. Make sure to follow "2. Instructions for installing controllers" in "Common Safety Instructions for Controllers", when tightening thread. Too much tightening may cause a malfunction of poppet.
2. In case the pressure difference between the primary pressure and the secondary pressure is extremely large, it may cause damage to the poppet during operation. The fragment of broken poppet may flow into the secondary side in the worst case.
3. Abnormal noise by chattering poppet may occur, depending on an operation pressure or flow rate.

Warning

1. Frequent switching may generate heat and cause a danger of getting burnt. Contact us in case of using Check Valve with frequent switching.
2. When the fluid medium is liquid, make sure to use Insert Ring together with. There is a risk of tube coming-off or leakage without Insert Ring.
3. When the fluid medium is chemicals or mixed gases, please check chemical resistance before actual use. Some conditions can cause damage of Push-in fitting, tube coming off or leakage.
4. Do not use this series under the condition with vibration or physical impact. These may cause damage to the products, the escape of tubes and a fluid leakage.
5. Resin can be deteriorated by being exposed to direct sunlight or ultraviolet rays.
6. Max. operating pressure for this product differs according to operating temperature range. Please make sure to check the chart "Relation of Operating Temp. & Max. Operating Pressure" and use the product within the specification range.

Caution

1. In case the pressure difference between the primary pressure and the secondary pressure is extremely large, it may cause damage to the poppet during operation. The fragment of broken poppet may flow into the secondary side in the worse case.
2. Abnormal noise by chattering poppet may occur, depending on an operation pressure or flow rate.
3. The seal rubber material EPDM is not suitable for general air piping, due to its inferior durability against mineral oil.
4. If there is a possibility of fire by a fluid leakage, implement specific counter measures such as using a protective cover in order to protect machines/facilities from damages or fire.
5. For Low Operating Pressure Type, min. checking differential pressure should be above 10kPa. Use with checking differential pressure under 10kPa may cause leakage.
6. When pressure is applied consecutively in the checking direction on Low Operating Pressure Type, opening pressure may be higher than the catalog specification depending on ambient temperature, pressure applying time and other conditions.
7. Corrosiveness and dusting characteristics differs depending on environment. When negative effect is expected on machines or apparatus, please conduct evaluation considering the environment before actual use at user's side.

■ How to insert and disconnect

1. How to insert and disconnect tubes

① Tube insertion

Insert a tube into Push-In Fitting up to the tube end. Lock-claws bite the tube and fix it automatically, then the elastic sleeve seals around the tube.

Refer to "2. Instructions for Tube Insertion" under "Common Safety Instructions for Fittings" .

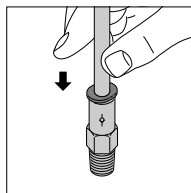

② Tube disconnection

The tube is disconnected by pushing release-ring to release Lock-claws.

Make sure to stop air supply before the tube disconnection.

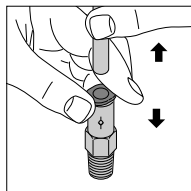

2. How to tighten thread

① Tightening thread

Use a spanner to tighten a hexagonal-column.

Refer to "Table: Recommended tightening torque" under "2. Instructions for Installing Controllers" in "Common Safety Instructions for Controllers".

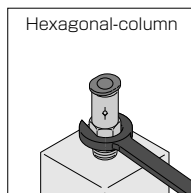



SAFETY Instructions

This safety instructions aim to prevent personal injury and damage to properties by requiring proper use of PISCO products.

Be certain to follow ISO 4414 and JIS B 8370

ISO 4414 : Pneumatic fluid power...Recommendations for the application of equipment to transmission and control systems.

JIS B 8370 : General rules and safety requirements for systems and their components.

This safety instructions is classified into "Danger", "Warning" and "Caution" depending on the degree of danger or damages caused by improper use of PISCO products.



Danger

Hazardous conditions. It can cause death or serious personal injury.



Warning

Hazardous conditions depending on usages. Improper use of PISCO products can cause death or serious personal injury.



Caution

Hazardous conditions depending on usages. Improper use of PISCO products can cause personal injury or damages to properties.



Warning

1. Selection of pneumatic products

- ① A user who is a pneumatic system designer or has sufficient experience and technical expertise should select PISCO products.
- ② Due to wide variety of operating conditions and applications for PISCO products, carry out the analysis and evaluation on PISCO products. The pneumatic system designer is solely responsible for assuring that the user's requirements are met and that the application presents no health or safety hazards. All designers are required to fully understand the specifications of PISCO products and constitute all systems based on the latest catalog or information, considering any malfunctions.

2. Handle the pneumatic equipment with enough knowledge and experience

- ① Improper use of compressed air is dangerous. Assembly, operation and maintenance of machines using pneumatic equipment should be conducted by a person with enough knowledge and experience.

3. Do not operate machine / equipment or remove pneumatic equipment until safety is confirmed.

- ① Make sure that preventive measures against falling work-pieces or sudden movements of machine are completed before inspection or maintenance of these machine.
- ② Make sure the above preventive measures are completed. A compressed air supply and the power supply to the machine must be off, and also the compressed air in the systems must be exhausted.
- ③ Restart the machines with care after ensuring to take all preventive measures against sudden movements.



SAFETY INSTRUCTION MANUAL

PISCO products are designed and manufactured for use in general industrial machines. Be sure to read and follow the instructions below.

Danger

1. Do not use PISCO products for the following applications.
 - ① Equipment used for maintaining / handling human life and body.
 - ② Equipment used for moving / transporting human.
 - ③ Equipment specifically used for safety purposes.

Warning

1. Do not use PISCO products under the following conditions.
 - ① Beyond the specifications or conditions stated in the catalog, or the instructions.
 - ② Under the direct sunlight or outdoors.
 - ③ Excessive vibrations and impacts.
 - ④ Exposure / adhere to corrosive gas, inflammable gas, chemicals, seawater, water and vapor. *
* Some products can be used under the condition above(④), refer to the details of specification and condition of each product.
2. Do not disassemble or modify PISCO products, which affect the performance, function, and basic structure of the product.
3. Turn off the power supply, stop the air supply to PISCO products, and make sure there is no residual air pressure in the pipes before maintenance and inspection.
4. Do not touch the release-ring of push-in fitting when there is a working pressure. The lock may be released by the physical contact, and tube may fly out or slip out.
5. Frequent switchover of compressed air may generate heat, and there is a risk of causing burn injury.
6. Avoid any load on PISCO products, such as a tensile strength, twisting and bending. Otherwise, there is a risk of causing damage to the products.
7. As for applications where threads or tubes swing / rotate, use Rotary Joints, High Rotary Joints or Multi-Circuit Rotary Block only. The other PISCO products can be damaged in these applications.
8. Use only Die Temperature Control Fitting Series, Tube Fitting Stainless SUS316 Series, Tube Fitting Stainless SUS316 Compression Fitting Series or Tube Fitting Brass Series under the condition of over 60°C (140° F) water or thermal oil. Other PISCO products can be damaged by heat and hydrolysis under the condition above.
9. As for the condition required to dissipate static electricity or provide an antistatic performance, use EG series fitting and antistatic products only, and do not use other PISCO products. There is a risk that static electricity can cause system defects or failures.
10. Use only Fittings with a characteristic of spatter-proof such as Anti-spatter or Brass series in a place where flame and weld spatter is produced. There is a risk of causing fire by sparks.
11. Turn off the power supply to PISCO products, and make sure there is no residual air pressure in the pipes and equipment before maintenance. Follow the instructions below in order to ensure safety.
 - ① Make sure the safety of all systems related to PISCO products before maintenance.
 - ② Restart of operation after maintenance shall be proceeded with care after ensuring safety of the system by preventive measures against unexpected movements of machines and devices where pneumatic equipment is used.
 - ③ Keep enough space for maintenance when designing a circuit.
12. Take safety measures such as providing a protection cover if there is a risk of causing damages or fires on machine / facilities by a fluid leakage.

⚠ Caution

1. Remove dusts or drain before piping. They may get into the peripheral machine / facilities and cause malfunction.
2. When inserting an ultra-soft tube into push-in fitting, make sure to place an Insert Ring into the tube edge. There is a risk of causing the escape of tube and a fluid leakage without using an Insert Ring.
3. The product incorporating NBR as seal rubber material has a risk of malfunction caused by ozone crack. Ozone exists in high concentrations in static elimination air, clean-room, and near the high-voltage motors, etc. As a countermeasure, material change from NBR to HNBR or FKM is necessary. Consult with PISCO for more information.
4. Special option "Oil-free" products may cause a very small amount of a fluid leakage. When a fluid medium is liquid or the products are required to be used in harsh environments, contact us for further information.
5. In case of using non-PISCO brand tubes, make sure the tolerance of the outer tube diameter is within the limits of Table 1.

● Table 1. Tube O.D. Tolerance

mm size	Nylon tube	Polyurethane tube	inch size	Nylon tube	Polyurethane tube
ø1.8mm	—	± 0.05mm	ø1/8	± 0.1mm	± 0.15mm
ø3mm	—	± 0.15mm	ø5/32	± 0.1mm	± 0.15mm
ø4mm	± 0.1mm	± 0.15mm	ø3/16	± 0.1mm	± 0.15mm
ø6mm	± 0.1mm	± 0.15mm	ø1/4	± 0.1mm	± 0.15mm
ø8mm	± 0.1mm	± 0.15mm	ø5/16	± 0.1mm	± 0.15mm
ø10mm	± 0.1mm	± 0.15mm	ø3/8	± 0.1mm	± 0.15mm
ø12mm	± 0.1mm	± 0.15mm	ø1/2	± 0.1mm	± 0.15mm
ø16mm	± 0.1mm	± 0.15mm	ø5/8	± 0.1mm	± 0.15mm

6. Instructions for Tube Insertion

- ① Make sure that the cut end surface of the tube is at right angle without a scratch on the surface and deformations.
- ② When inserting a tube, the tube needs to be inserted fully into the push-in fitting until the tubing edge touches the tube end of the fitting as shown in the figure below. Otherwise, there is a risk of leakage.

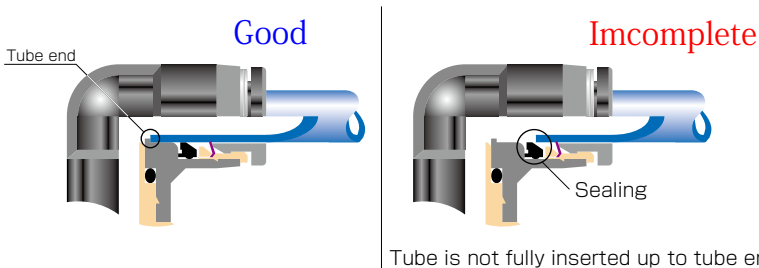

- ③ After inserting the tube, make sure it is inserted properly and not to be disconnected by pulling it moderately.
- ※ When inserting tubes, Lock-claws may be hardly visible in the hole, observed from the front face of the release-ring. But it does not mean the tube will surely escape. Major causes of the tube escape are the followings;
- ① Shear drop of the lock-claws edge
 - ② The problem of tube diameter (usually small)
- Therefore, follow the above instructions from ① to ③, even lock-claws is hardly visible.

7. Instructions for Tube Disconnection

- ① Make sure there is no air pressure inside of the tube, before disconnecting it.
- ② Push the release-ring of the push-in fitting evenly and deeply enough to pull out the tube toward oneself. By insufficient pushing of the release-ring, the tube may not be pulled out or damaged by scratch, and tube shavings may remain inside of the fitting, which may cause the leakage later.

8. Instructions for Installing a fitting

- ① When installing a fitting, use proper tools to tighten a hexagonal-column or an inner hexagonal socket. When inserting a hex key into the inner hexagonal socket of the fitting, be careful so that the tool does not touch lock-claws. The deformation of lock-claws may result in a poor performance of systems or an escape of the tube.
- ② Refer to Table 2 which shows the recommended tightening torque. Do not exceed these limits to tighten a thread. Excessive tightening may break the thread part or deform the gasket and cause a fluid leakage. Tightening thread with tightening torque lower than these limits may cause a loosened thread or a fluid leakage.
- ③ Adjust the tube direction while tightening thread within these limits, since some PISCO products are not rotatable after the installation.

● Table 2: Recommended tightening torque / Sealock color / Gasket materials

Thread type	Thread size	Tightening torque	Sealock color	Gasket materials
Metric thread	M3 × 0.5	0.7N·m	—	SUS304 NBR
	M5 × 0.8	1.0 ~ 1.5N·m		
	M6 × 1	2 ~ 2.7N·m		
	M3 × 0.5	0.5 ~ 0.6N·m		POM
	M5 × 0.8	1 ~ 1.5N·m		
	M6 × 0.75	0.8 ~ 1N·m		
Taper pipe thread	M8 × 0.75	1 ~ 2N·m	White	—
	R1/8	7 ~ 9N·m		
	R1/4	12 ~ 14N·m		
	R3/8	22 ~ 24N·m		
Unified thread	R1/2	28 ~ 30N·m	—	SUS304, NBR
	No.10-32UNF	1.0 ~ 1.5N·m		
National pipe thread taper	1/16-27NPT	7 ~ 9N·m	White	—
	1/8-27NPT	7 ~ 9N·m		
	1/4-18NPT	12 ~ 14N·m		
	3/8-18NPT	22 ~ 24N·m		
	1/2-14NPT	28 ~ 30N·m		

※ These values may differ for some products. Refer to each specification as well.

9. Instructions for removing a fitting

- ① When removing a fitting, use proper tools to loosen a hexagonal-column or an inner hex bolt.
- ② Remove the sealant stuck on the mating equipment. The remained sealant may get into the peripheral equipment and cause malfunctions.

10. Arrange piping avoiding any load on fittings and tubes such as twist, tensile, moment load, shaking and physical impact. These may cause damages to fittings, tube deformations, bursting and the escape of tubes.

Common Safety Instructions for Controllers

Before selecting or using PISCO products, read the following instructions. Read the detailed instructions for individual series as well as the instructions below.

Warning

1. Some products have an air direction to control. Make sure to distinguish the direction by marking on the products. Installing the product with the wrong direction may cause personal injury or property damage.
2. Avoid any load on PISCO products such as a tensile strength, twisting, bending, dropping and excessive impacts. These may cause damage to the products.
3. Locknut needs to be tightened by hand. Do not use any tool. Using tools to tighten the locknut may cause damage to the products. Also, inadequate tightening may loosen the locknut and the initial setting can be changed.
4. Use clean air to supply. Dusts and sludge may result in the change of the initial setting.

Disclaimer

1. PISCO does not take any responsibility for any incidental or indirect loss, such as production line stop, interruption of business, loss of benefits, personal injury, etc., caused by any failure on use or application of PISCO products.
2. PISCO does not take any responsibility for any loss caused by natural disasters, fires not related to PISCO products, acts by third parties, and intentional or accidental damages of PISCO products due to incorrect usage.
3. PISCO does not take any responsibility for any loss caused by improper usage of PISCO products such as exceeding the specification limit or not following the usage the published instructions and catalog allow.
4. PISCO does not take any responsibility for any loss caused by remodeling of PISCO products, or by combinational use with non-PISCO products and other software systems.
5. The damages caused by the defect of Pisco products shall be covered but limited to the full amount of the PISCO products paid by the customer.

Caution

1. Refer to "Common Safety Instructions for Fittings" for the safety instructions for fitting part.
2. Instructions for Installing Controllers
 - ① Use proper tools to tighten a hexagonal-column or a knurling, when installing the controller.
 - ② Refer to the following table which shows the recommended tightening torque to tighten thread. Excessive tightening may break the thread part or deform the gasket to cause a fluid leakage. Tightening thread with the tightening torque lower than these limits may cause a loosened thread or a fluid leakage.

● Table: Recommended tightening torque

(hexagonal-column)

Thread type	Thread size	Tightening torque
Metric thread	M3 × 0.5	0.7Nm
	M5 × 0.8	1 ~ 1.5Nm
	M6 × 1	2 ~ 2.7Nm
Taper pipe thread	R1/8	7 ~ 9Nm
	R1/4	12 ~ 14Nm
	R3/8	22 ~ 24Nm
	R1/2	28 ~ 30Nm
Unified thread	No.10-32UNF	1.5 ~ 1.9Nm
National pipe thread taper	1/16-28NPT	7 ~ 9Nm
	1/8-27NPT	7 ~ 9Nm
	1/4-18NPT	12 ~ 14Nm
	3/8-18NPT	22 ~ 24Nm
	1/2-14NPT	28 ~ 30Nm
Parallel pipe thread	G3/8	After hand tightening 1/2~1 turns
	G1/2	

(knurling)

Thread type	Thread size	Tightening torque
Metric thread	M5 × 0.8	1/6 turns after hand tightening
	M6 × 1	
	M10 × 1	
Parallel pipe thread	G3/8	1/2~1 turns after hand tightening
	G1/2	

3. Instructions for removing Controller

- ① When removing controllers, use proper tools to loosen a hexagonal-column or a knurling.
- ② Remove the sealant stuck on the mating equipment. The remained sealant may get into the peripheral equipment and cause malfunctions.

4. Fixed Orifice Joint Series and Speed Controller Constant Flow Series have deviation of flow rate. Contact us, in case a very accurate amount of flow rate is required.

5. If PISCO products generate heat by an adiabatic compression, total temperature including the heat from the product must be controlled within the range of the specification.