

Features

Accessories to customize and enhance our standard product line are sold separately

● Operators:

Armored button Foot Pedal
Ball Operator Cam Operators
Air Pilot Thumb Operator
Shrouded Button Operator
Heavy Duty Operator

● Mounting Brackets

● Dress Plates

● Micro Gauge



Valve Accessories

Ball Operators

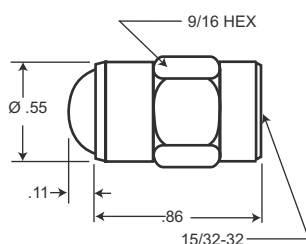

Note: One 5/64" thick locknut (provided) is required when installed without a mounting bracket.

Designed for use on Pneumadyne push button valves (15/32-32 Thd). A captured stainless steel ball bearing has direct contact with the valve button. (Not for use on "4" Series valves)

Product Information

Part Number	Max. Stroke	Mounting
BA-1	.11"	15/32-32 (F)

● Refer to [Force to Actuate chart](#) for actuation information.

Materials

Brass/ Electroless Nickel, Stainless Steel

External Air Pilot Operators

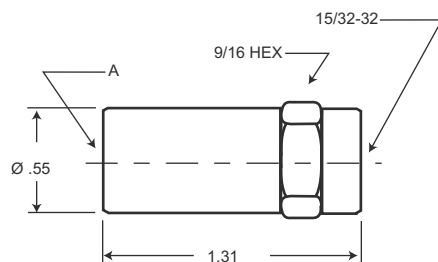

Note: One 5/64" thick locknut (provided) is required when installed without a mounting bracket.

Designed for use on Pneumadyne push button valves (15/32-32 Thd) and available in two port sizes. A brass piston and Buna-N cup seal ensure consistent leakproof actuation (the valve returns the piston). Ideal for remote actuation of valves using a pneumatic signal.

Product Information

Part Number	Air Pilot Port "A"	Mounting
AP-1	10-32 (F)	15/32-32 (F)
AP-2	1/8 NPT (F)	15/32-32 (F)

● Refer to [Force to Actuate chart](#) for actuation information.

Materials

Brass/ Electroless Nickel, Buna-N

Low Pressure Air Pilot Operator

Designed for use with Pneumadyne push button valves. The design of the internal piston in conjunction with a low friction u-cup minimizes drag allowing faster valve actuation. 10-32 (F) pilot port for use with Pneumadyne o-ring style barb and push-to connect fittings.

Product Information

Part Number	Mounting
APLP-1	15/32-32 (F)

- Refer to [Force to Actuate chart](#) for actuation information.

Materials

Aluminum/ Anodize, Aluminum/ Electroless Nickel, Aluminum, Buna-N

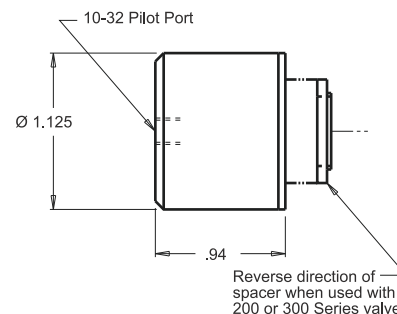

Note: One 5/64" thick locknut (provided) is required when installed without a mounting bracket.

Shrouded Button Operator

Designed for use with Pneumadyne push button valves, the Shrouded Button provides a larger tactile surface for actuation. Available in three colors. Replace the "X" in the part number with the desired color code number.

Product Information

Part Number	Mounting	Description	Standard Available Color
PBF-X	15/32-32 (F)	Flush	2= Black 3= Red 5= Green
PBR-X	15/32-32 (F)	Raised	

- Refer to [Force to Actuate chart](#) for actuation information.

Materials

Aluminum/ Anodize, Aluminum/ Electroless Nickel, Brass

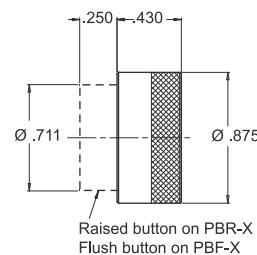

Note: One 5/64" thick locknut (provided) is required when installed without a mounting bracket.

- When design makes a dimension critical- contact factory for confirmation. All dimensions shown subject to change without notice.

Heavy Duty Operator

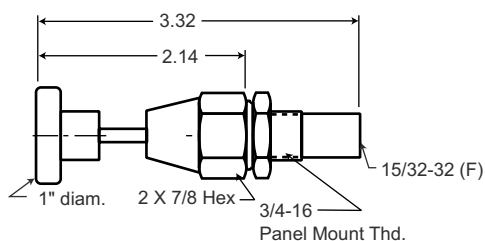

The heavy duty operator is designed for use on Pneumadyne push button valves and is available in **push** and **push-to-lock** styles. Ideal for heavy duty industrial use.

Product Information

Part Number	Style	Max Stroke	Mounting Holes
HDO	Push	.35	3/4"
HDOL	Push-to-Lock	.35	3/4"

- Refer to [Force to Actuate chart](#) for actuation information.

Stroke ratio defined in glossary (pg 225)

Materials

Aluminum/ Black Anodize, Brass, Steel, Buna-N, Stainless Steel/ Zinc

Foot, Hand, Knee Operator

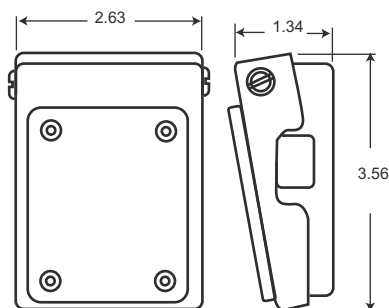

One locknut and designated spacer are required for installation (locknut supplied with valve)

Designed for use with Pneumadyne "O", "11" and "300" Series valves. An adhesive backed thick rubber pad is riveted to the steel pedal for skid resistance and comfort.
(Not for use on "4" or "45" 1/8 NPT Series valves)

Product Information

Part Number	Max. Stroke
FPA	Approximately .20"

- Refer to [Force to Actuate chart](#) for actuation information.

Materials

Steel/ Dichromate, Stainless Steel, Aluminum, Brass, Buna-N

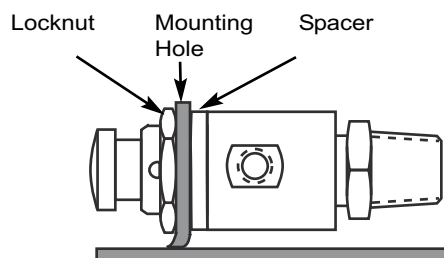

Cam Operators

Designed for use on Pneumadyne push button valves and available in three styles. All are manufactured from steel with electro nickel plating. The roller is manufactured from durable acetal plastic. All cams feature a unique acetal pad which minimizes side load and virtually eliminates wear.

(Not for use on "4" Series valves)

Product Information

Part Number	Stroke Ratio	Mounting Holes
CA-1	2.1	31/64"
CA-2	2.5	31/64"
CA-4	6	31/64"

- Refer to [Force to Actuate chart](#) for actuation information.

Stroke ratio defined in glossary (pg 225)

Must be installed with a mounting bracket MB-1 or MB-1F, or 5/64" thick nut (supplied with valve).

Materials

Steel/ Electroless Nickel, Acetal, Stainless Steel

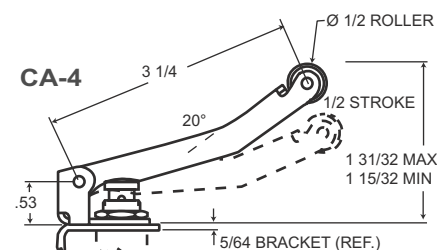
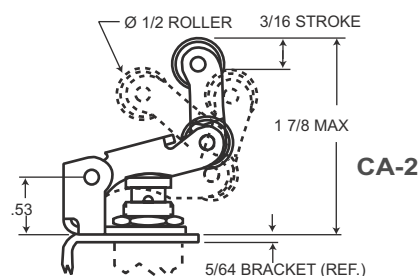
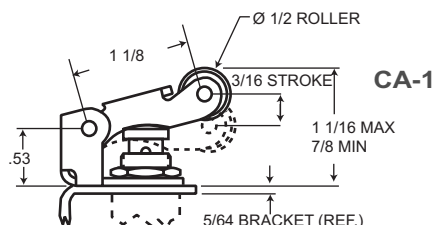

Thumb Operators

Designed for use on Pneumadyne push button valves to provide greater tactile surface and reduce operator fatigue. Features a unique acetal pad which minimizes side load and virtually eliminates wear. (Not for use on "4" Series valves)

Product Information

Part Number	Stroke Ratio	Mounting Holes
TA-1	2.7	31/64"

- Refer to [Force to Actuate chart](#) for actuation information.

Stroke ratio defined in glossary (pg 225)

Materials

Steel/ Electroless Nickel, Acetal, Stainless Steel

- When design makes a dimension critical- contact factory for confirmation. All dimensions shown subject to change without notice.

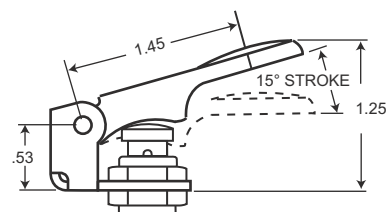

TA-1



- To prevent pre-stroking **All** cam operators must be installed with a mounting bracket, MB-1 or MB-1F or 5/64" thick nut (supplied with the valve).

Force to Actuate

Valve Accessory Part Number

Pneumadyne Product Line
Force to Actuate

	AB-1 AB-2 Lbs	AP-1 AP-2 psi	APLP-1 psi	BA-1 Lbs	CA-1 Lbs	CA-2 Lbs	CA-4 Lbs	FPA Lbs	HDO Lbs	PBF-X PBR-X Lbs	TA-1 Lbs
"O" Series; NO											
50 psi	3.00	25	3.6	3.00	1.50	1.25	.50	3-6	6.00	3.00	1.25
125 psi	5.30	44	6.4	5.30	2.50	2.25	1.00	3-6	8.75	5.30	2.25
"O" Series; NC											
50 psi	3.20	26	3.8	3.20	1.50	1.25	.75	3-6	6.25	3.20	1.25
125 psi	5.70	47	6.8	5.70	2.75	2.25	1.00	3-6	9.25	5.70	2.25
"3" Series											
50 psi	3.50	29	4.2	3.50	1.75	1.50	.75	3-6	6.50	3.50	1.50
125 psi	6.10	51	7.4	6.10	3.00	2.50	1.00	3-6	9.50	6.10	2.50
"11" Series; NO											
50 psi	7.60	63	9.2	7.60	3.75	3.00	1.25	3-6	10.50	7.60	3.00
125 psi	11.00	91	13.3	11.00	5.25	4.50	2.00	3-6	14.50	11.00	4.50
"11" Series; NC											
50 psi	3.80	32	4.7	3.80	2.00	1.50	.75	3-6	6.75	3.80	1.50
125	7.20	60	8.7	7.20	3.50	3.00	1.25	3-6	10.75	7.20	3.00
"200" Series											
50 psi	1.90	16	2.3	1.90	1.00	1.00	.50	3-6	5.00	1.90	1.00
125 psi	3.20	26	3.8	3.20	1.75	1.25	.75		6.75	3.20	1.25
"300" Series											
50 psi	2.50	21	3.1	2.50	1.25	1.00	.50	3-6	5.50	2.50	1.00
125 psi	3.20	26	3.8	3.20	1.50	1.25	.75	3-6	6.75	3.20	1.25
"400" Series											
50 psi	3.40	28	4.1	3.40	1.75	1.5	.75	3-6	6.50	3.40	1.50
125 psi	5.30	44	6.4	5.30	2.50	2.25	1.00	3-6	8.75	5.30	2.25
"4" Series											
50 psi	3.00	45	5.5	3.00					6.00	3.00	
125 psi	3.00	45	5.5	3.00					6.00	3.00	
"45" Series											
50 psi	5.00	45	5.5	5.00	2.50	2.00	1.00	3-6	8.00	5.00	2.00
125 psi	8.00	45	5.5	8.00	4.00	3.25	1.50	3-6	11.50	8.00	3.25

Dress Plate

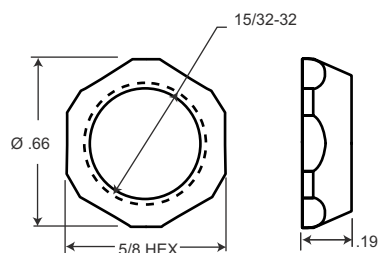
DP-11
DP-22

Dress plates are manufactured from aluminum and are either black anodized or electroless nickel plated for appearance and corrosion resistance. To provide a finished look first install the dress plate *on the valve* then tighten from *behind* the control panel.

Product Information

Part Number	Thread	Finish
DP-11	15/32-32	Black Anodize
DP-22	15/32-32	Electroless Nickel

Materials

Aluminum/ Black Anodize or Aluminum/ Electroless Nickel

Mounting Brackets

The flat and angled mounting brackets are manufactured from steel and provide a convenient method for mounting valves to a machine member.

Product Information

Part Number	Description
MB-1	90° angle bracket
MB-1F	flat bracket

Materials

Steel/ Electro Nickel

* One locknut and washer required to secure mounting bracket against valve shoulder.

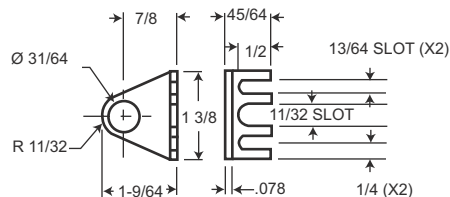

MB-1
90° angle mounting bracket

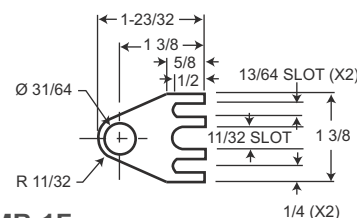

MB-1F
Flat mounting bracket

Micro Gauge

Ideal for space constrained applications that require separate pressure readings. The micro gauge is easily installed using the 1/8 NPT male thread. The micro gauge can be mounted on the Pneumadyne "11" Series regulators with an extended gauge port, providing a point of use pressure indicator.

Product Information

Part Number	Pressure Range	Temp. Range	Repeatability	Accuracy	Mounting	Hex
PMG-60	0-60 psi	-40° F to 150° F	+/-1%	+/- 5% Full Scale	1/8 NPT (M)	9/16
PMG-100	0-100 psi					
PMG-160	0-160 psi					

Materials

Bourdon Tube: Spiral Beryllium copper, soft soldered to socket
Pointer: Red painted brass
Dial: White/ Aluminum with black scale
Window: Polycarbonate
Fill: Dry
Case: Black ABS plastic

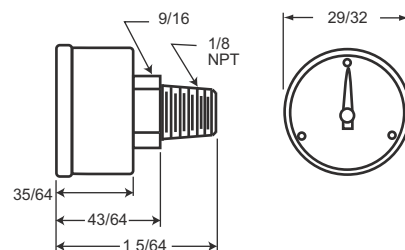

● When design makes a dimension critical- contact factory for confirmation. All dimensions shown subject to change without notice.

